



**Minipack-torre S.p.A.**  
Via Provinciale, 54 - 24044 Dalmine (BG) - Italy  
Tel. (035) 563525 – Fax (035) 564945  
E-mail: [info@minipack-torre.it](mailto:info@minipack-torre.it)  
<http://www.minipack-torre.it>



# Media Matic

## Spare parts catalogue

( Valid from serial number 102 dated 02.2000 up to 1283 dated 01.2011 )



CAREFULLY READ THIS CATALOGUE BEFORE ORDERING ANY SPARE PART



DOC. N. FM112018  
REV. 02  
ED. 09.2011

## INDEX OF SPARE PARTS GROUPS

<b>SCHEME</b>	<b>DESCRIPTION</b>	<b>PAGINA PAGE</b>
1	SEALING BLADE GROUP	2
2	CUTTER GROUP	3
3	FILM ROLL SUPPORT GROUP	4
4	CUTTER AUTOMATION GROUP	5
5	TRANSPORT BELT GROUP	6
6	COOLING GROUP	7
7	FILM WINDER GROUP	8
8	BODYWORK GROUP	9
9	CONVEYOR BELT TUNNEL GROUP (inlet side)	10
9.1	CONVEYOR BELT TUNNEL GROUP (outlet side)	11
9.2	CONVEYOR BELT TUNNEL GROUP (chain)	12
10	MOTOR + HEATERS GROUP	13
11	WIRING GROUP (control panel)	14
11.1	WIRING GROUP (box)	14
12	WIRING DIAGRAM	15-16
12.1	WIRING DIAGRAM DESCRIPTION	17

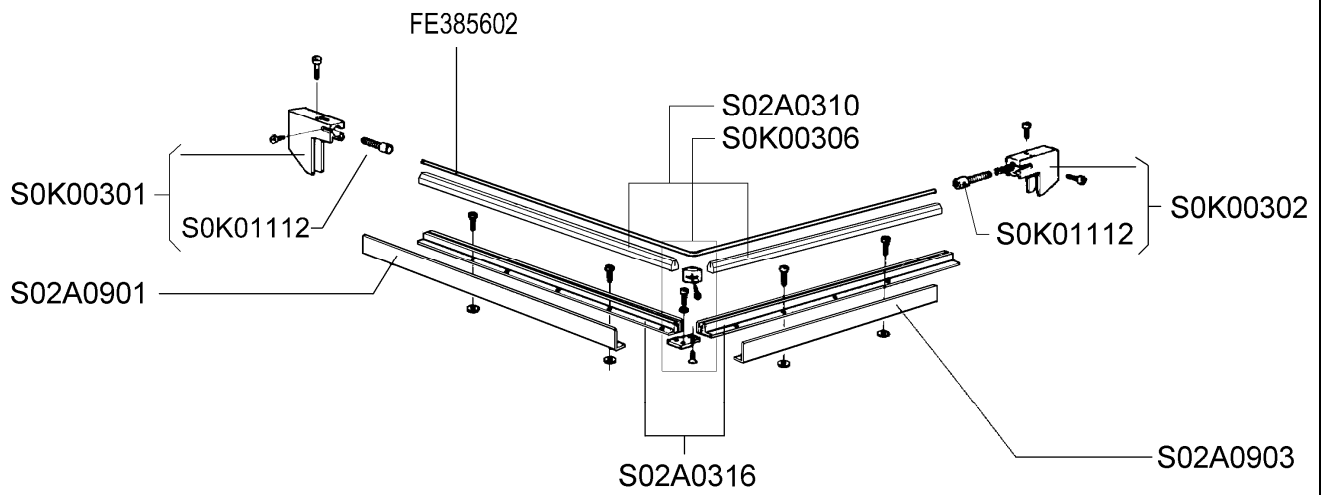

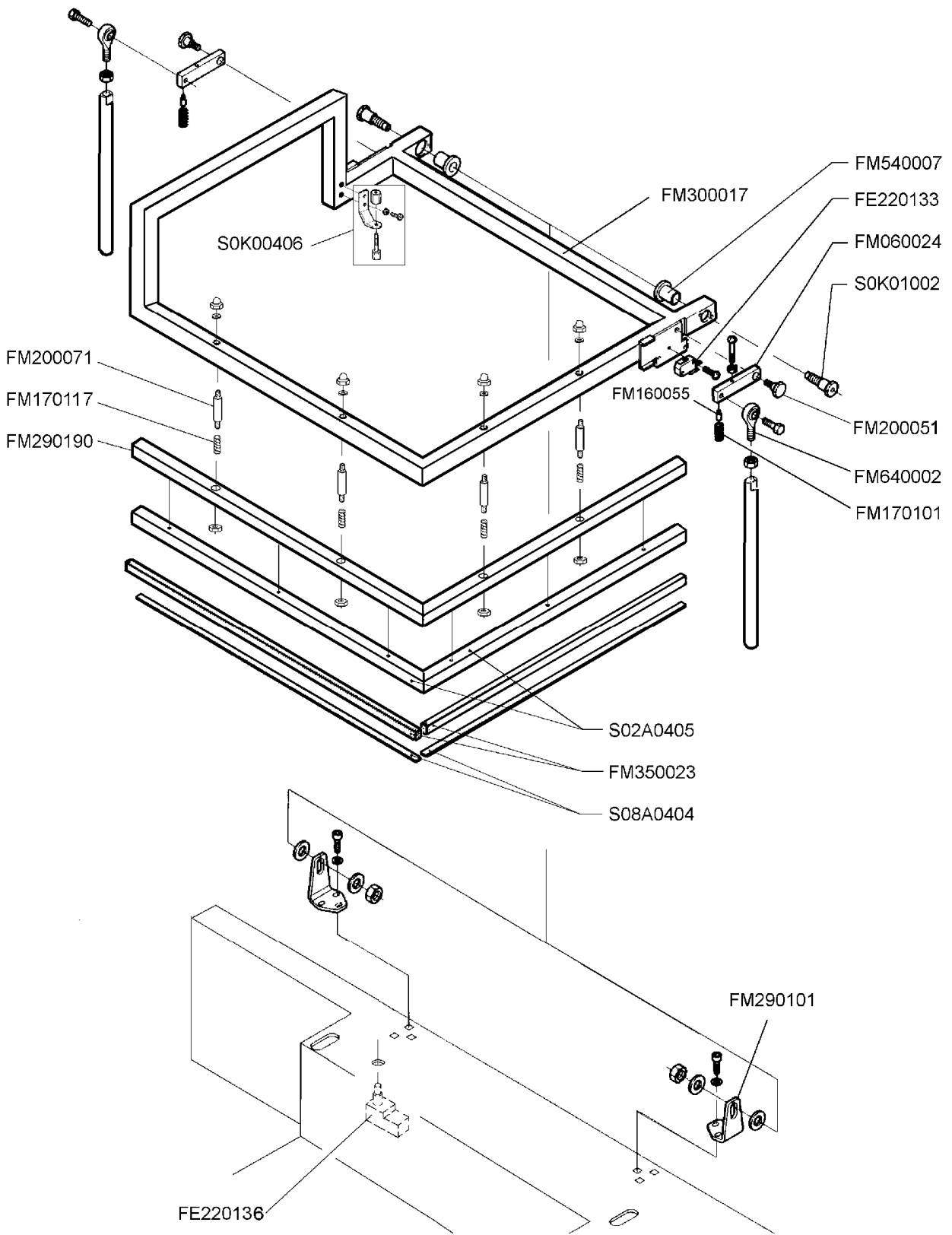

S03A0606

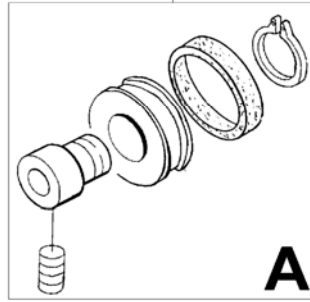

S03A0605

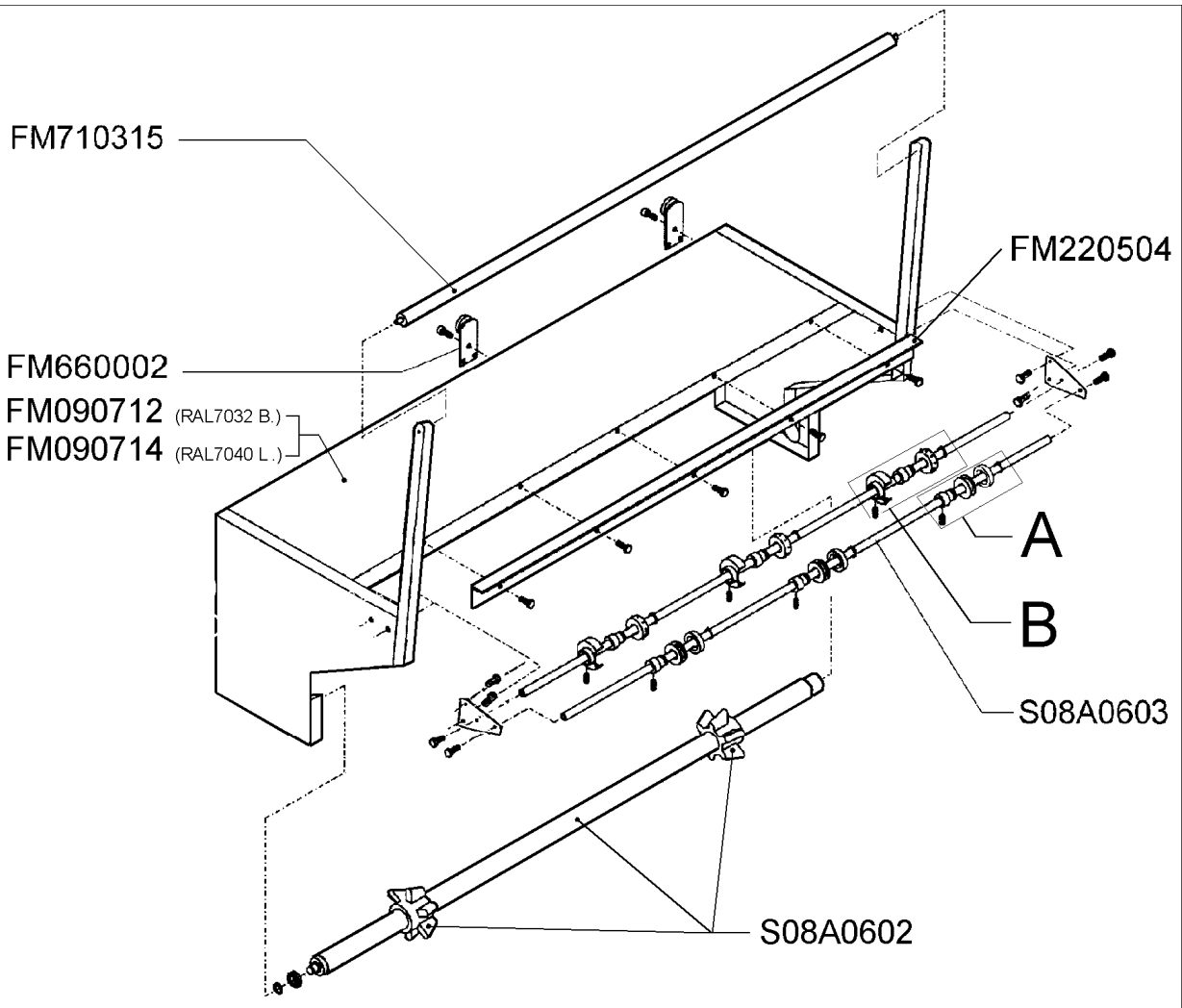
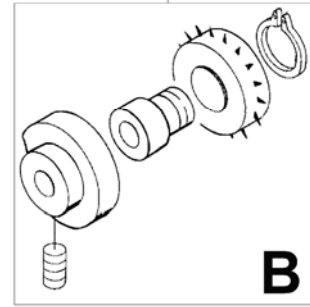

PB17B001 (RAL7032 B.)

PB17B002 (RAL7040 L.)

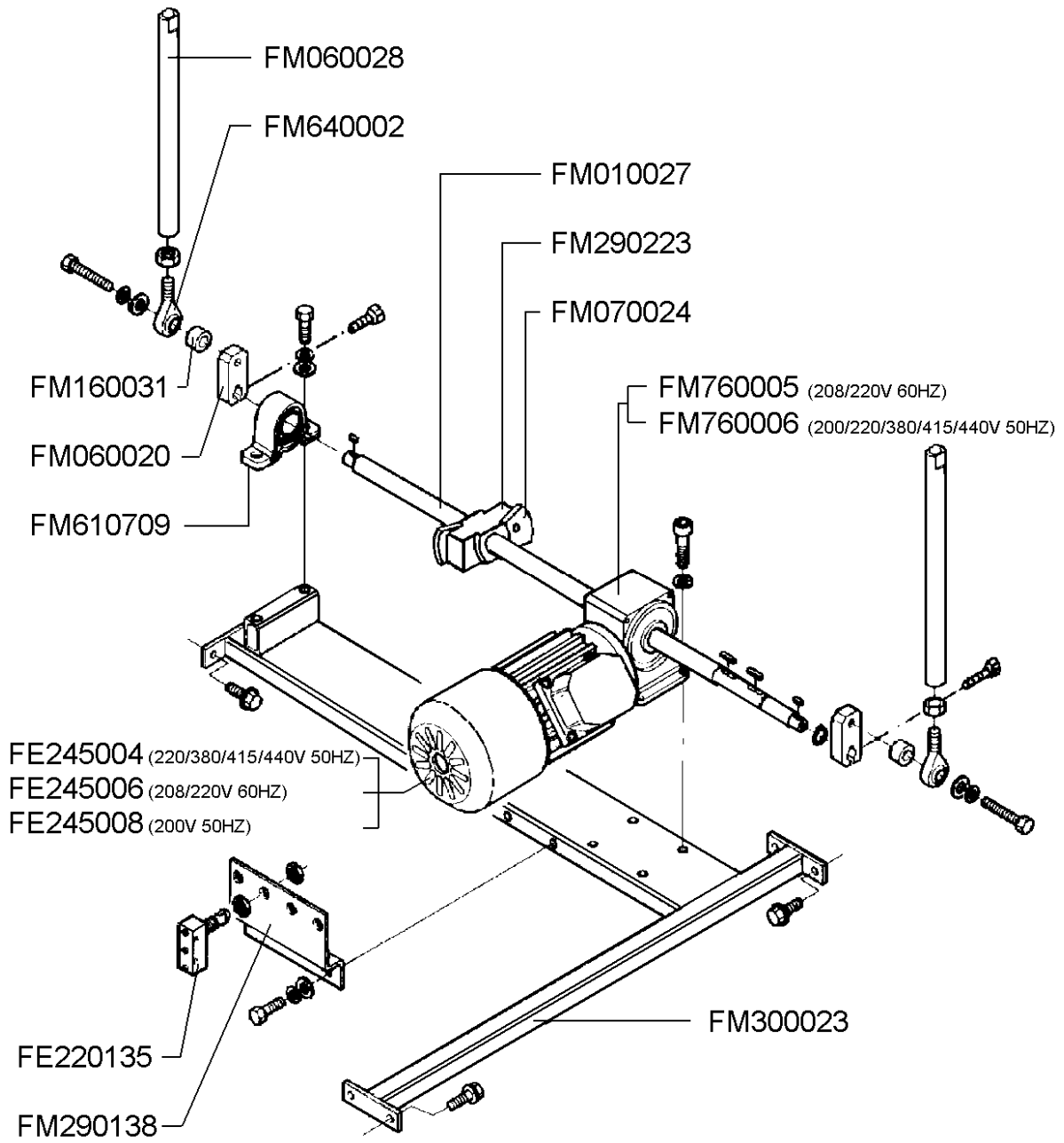

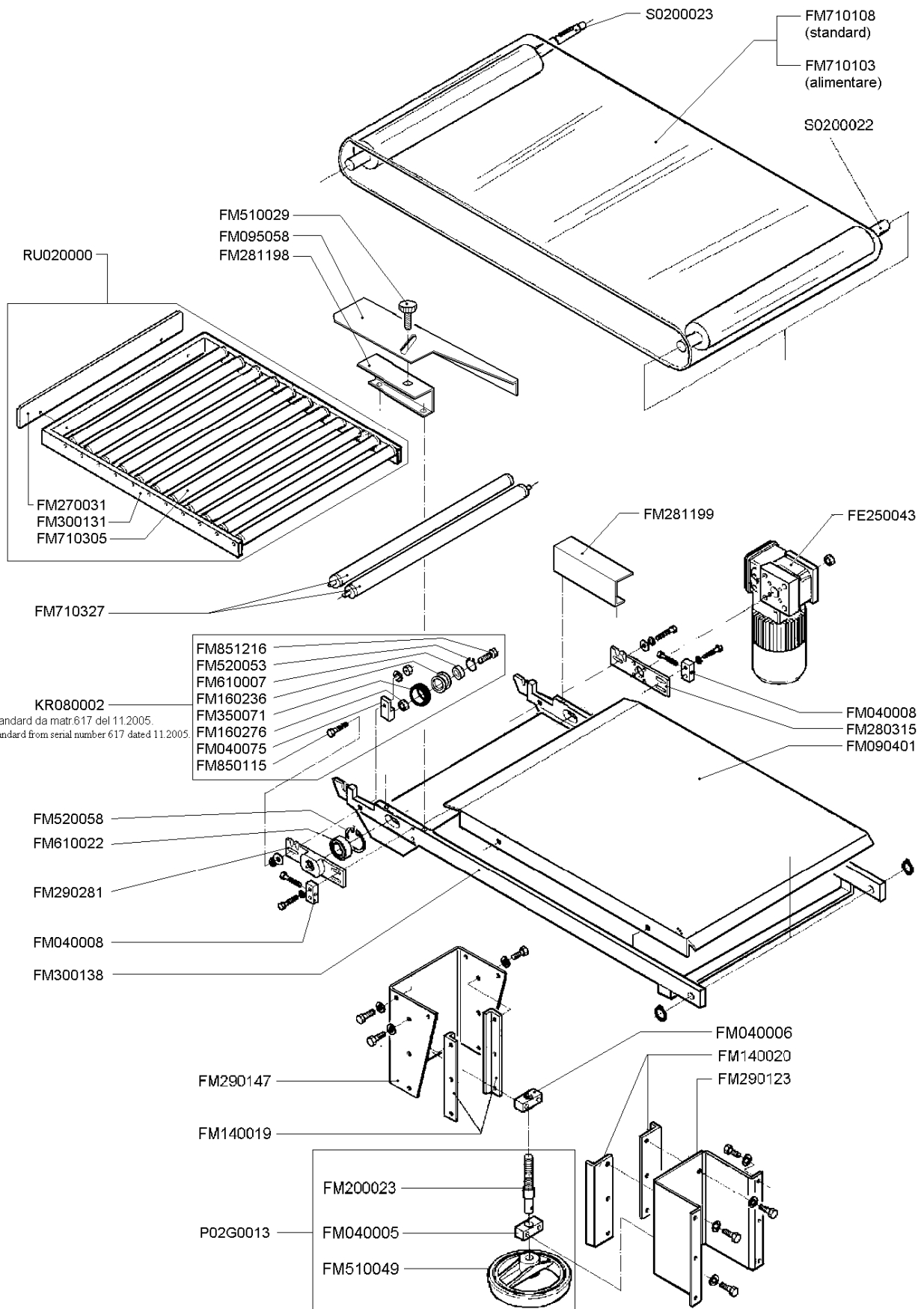

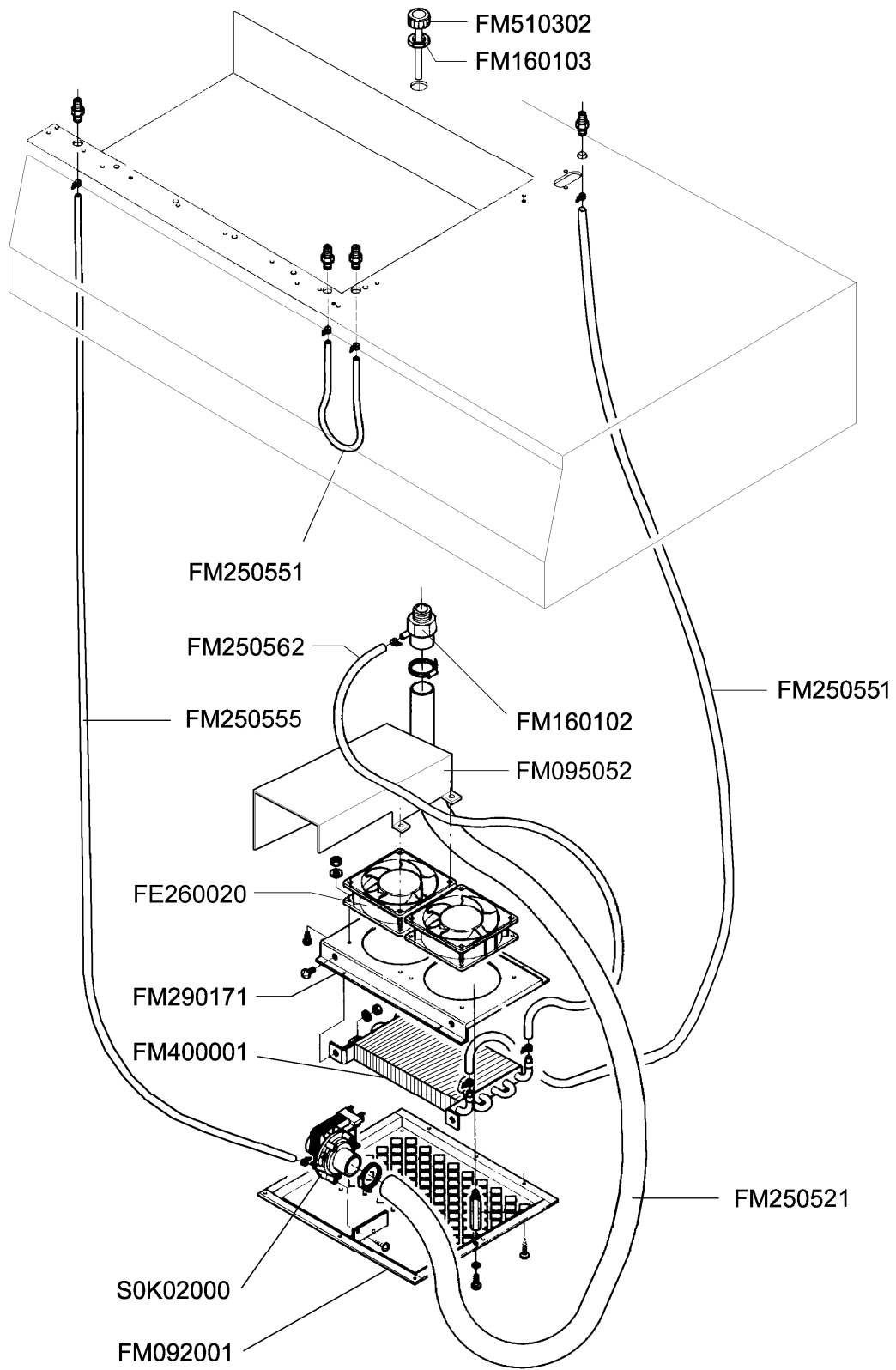



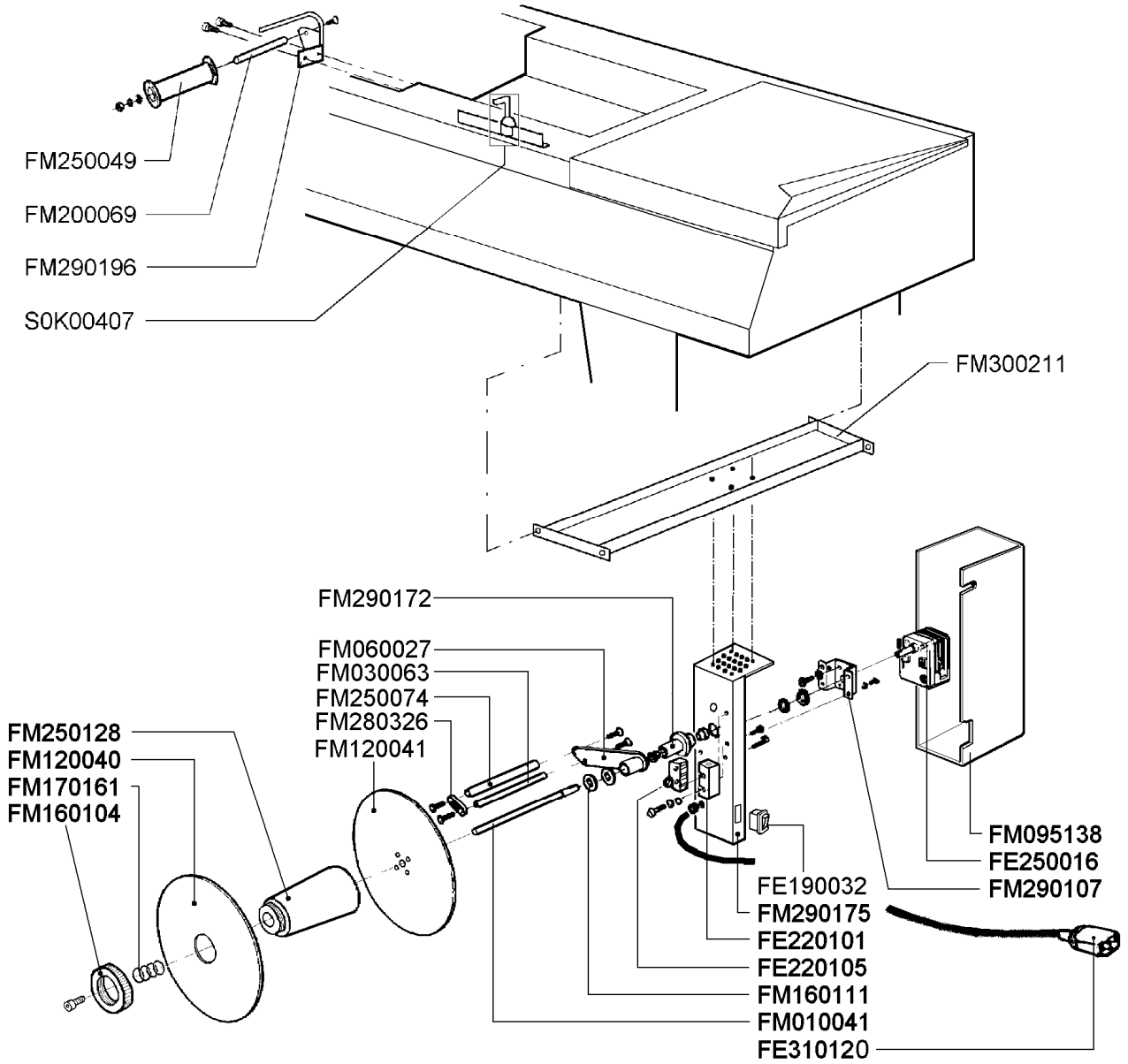

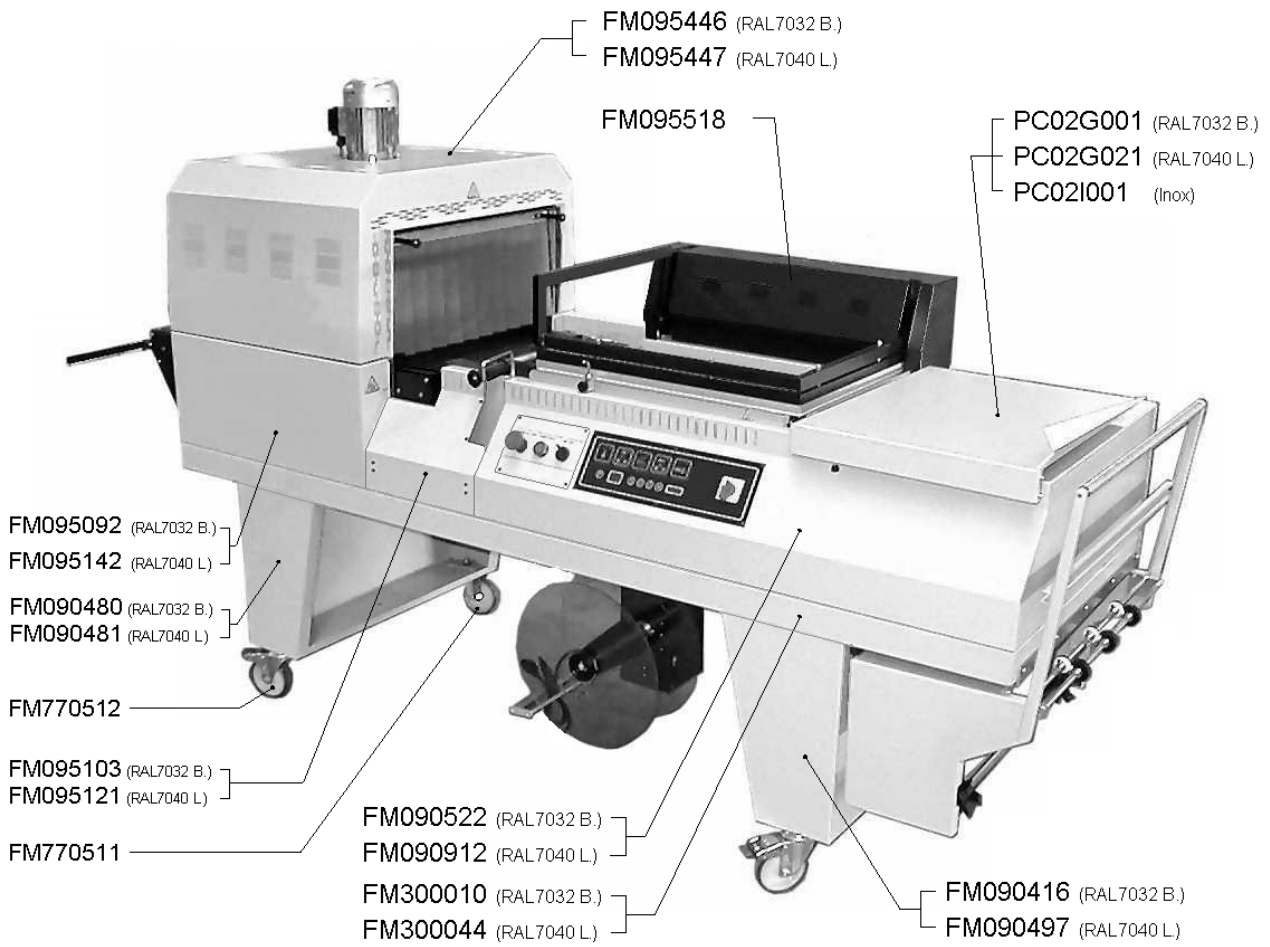

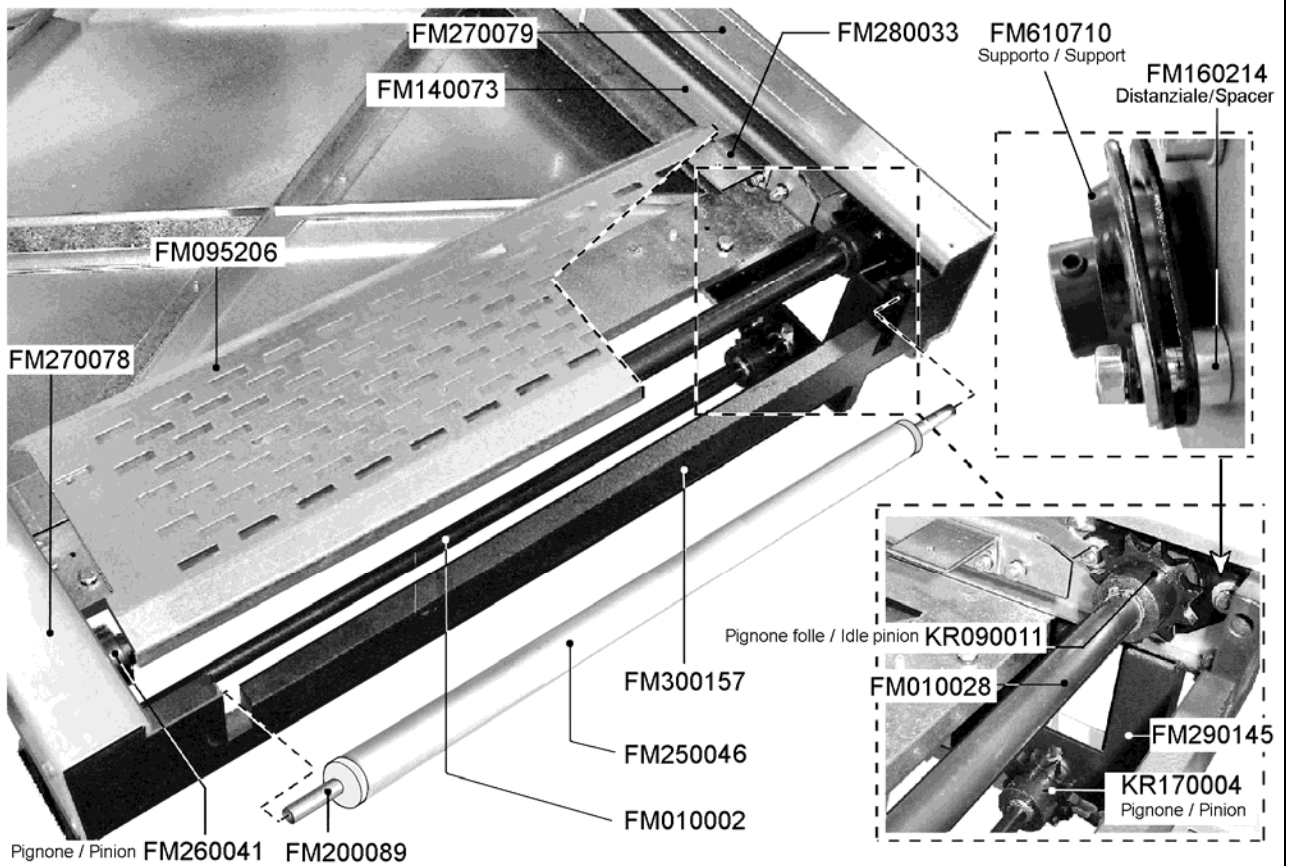
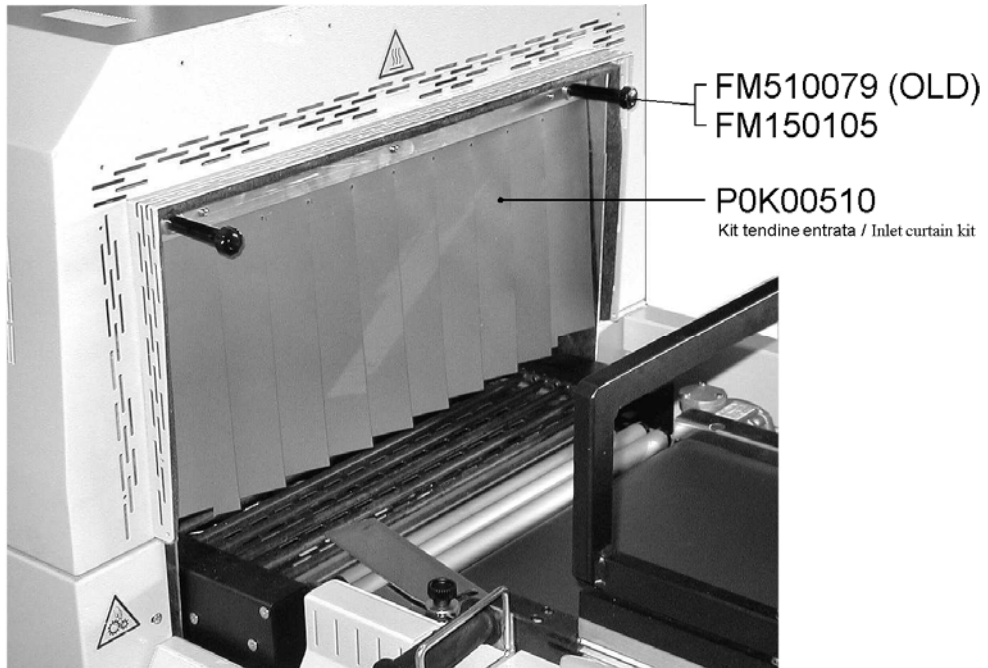

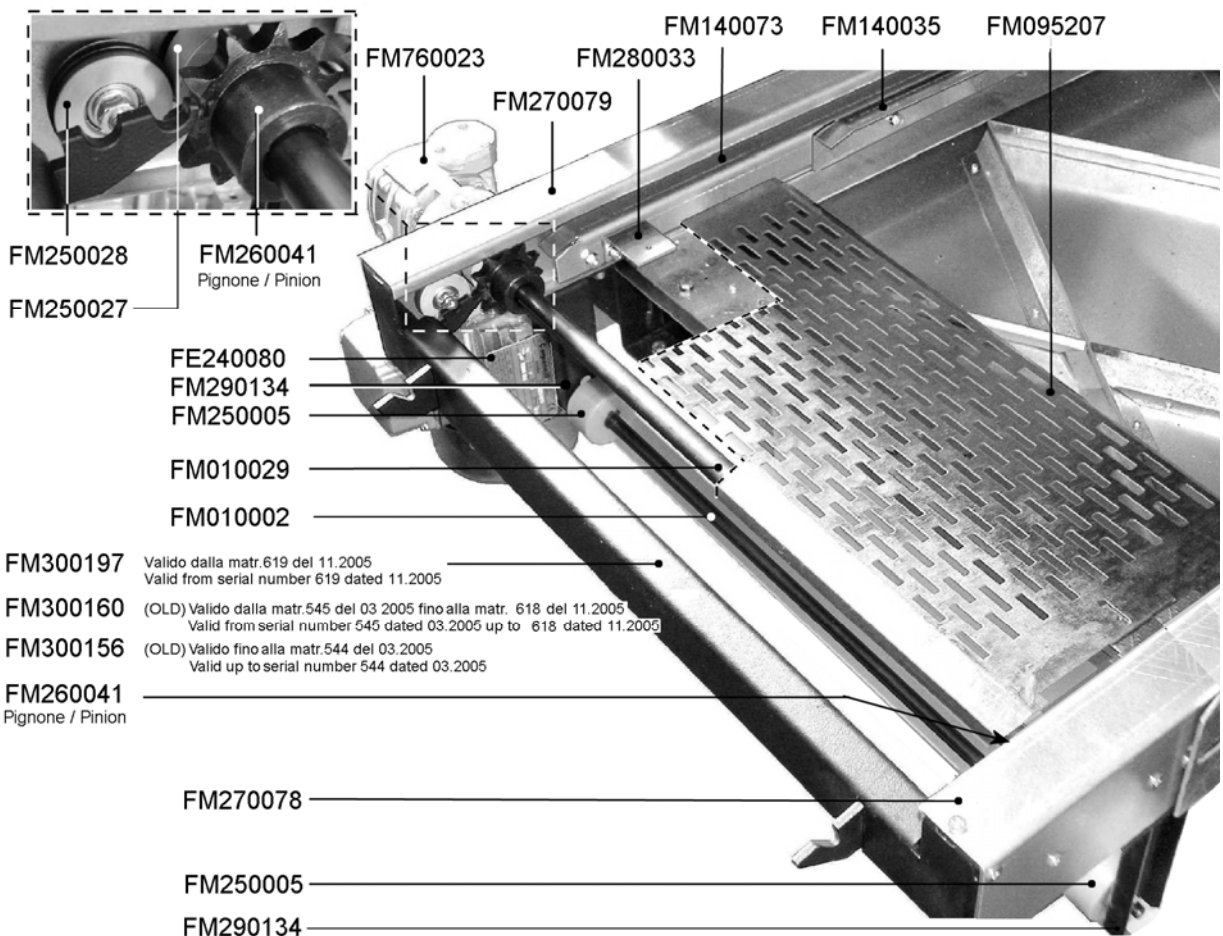
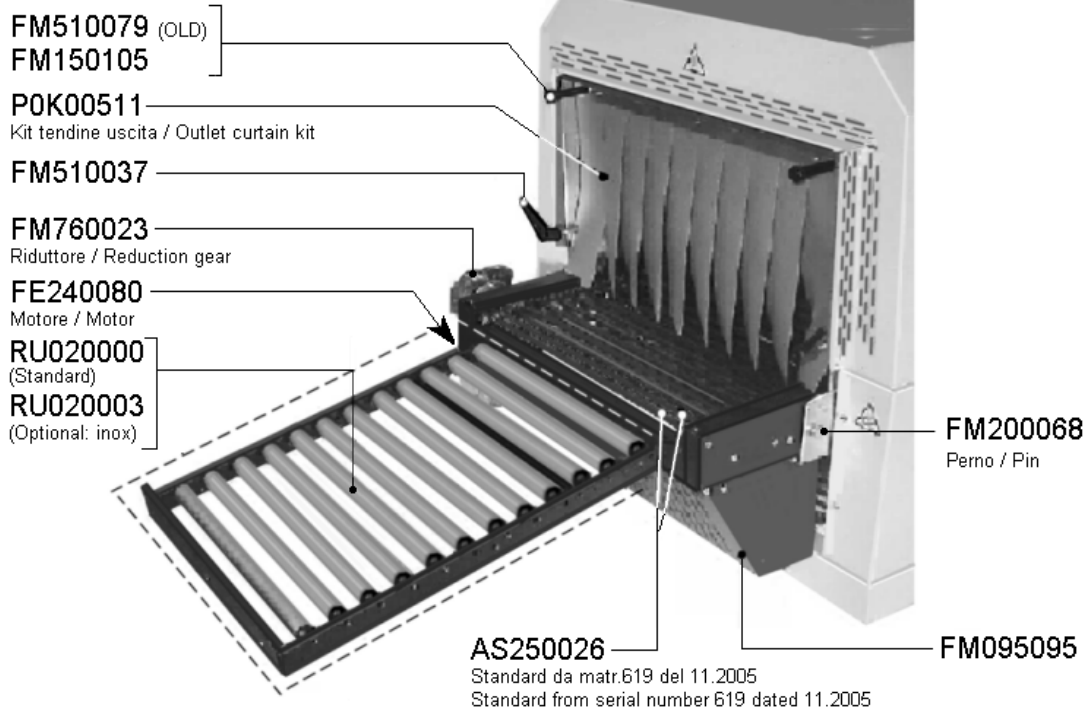

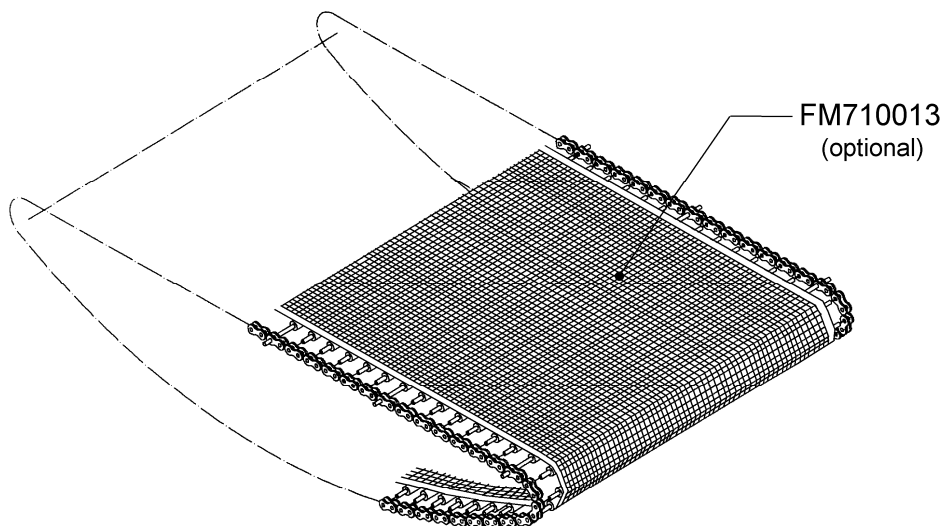
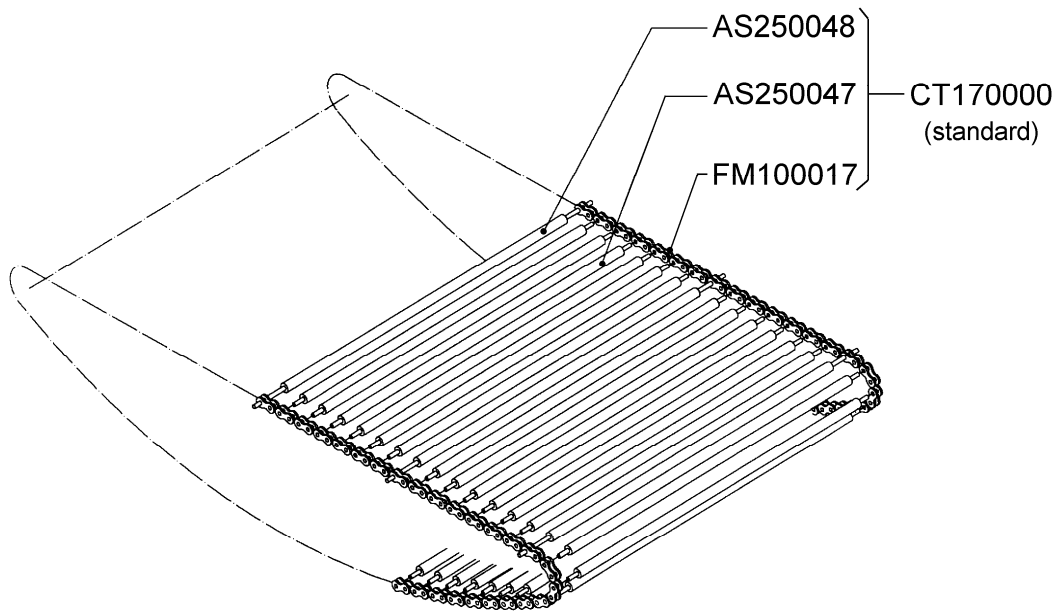

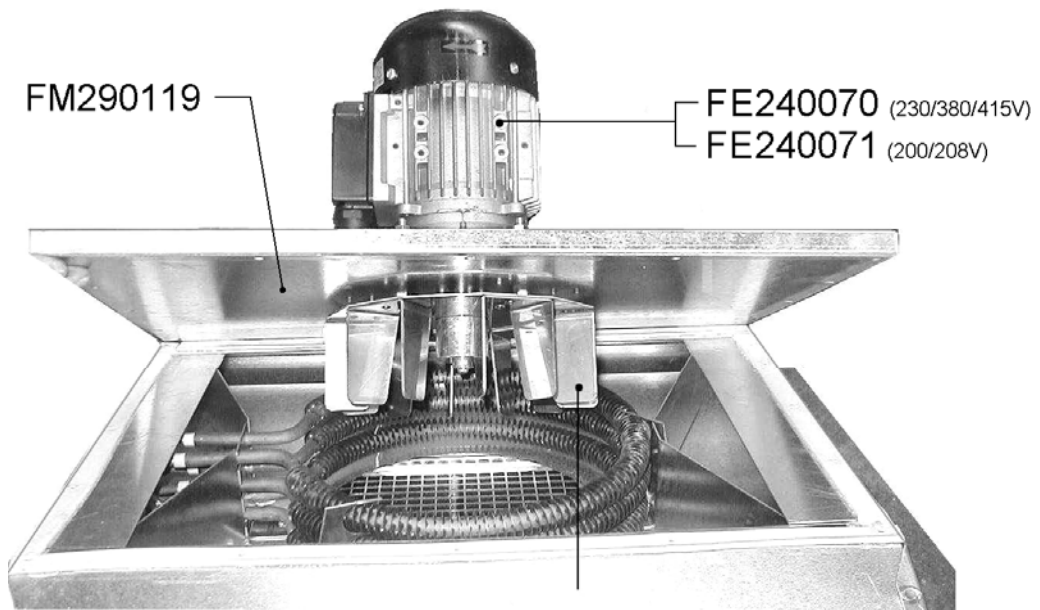

FM410003

Valido dalla matr.329 del 07.2002 e per le matr.313, 322, 324.  
Valid from serial number 329 dated 07.2002 and the same for 313, 322, 324.

FM830051

(Old)

**Valid from serial number 200 dated 04.2001 and the same for 188, 189, 190, 195.**

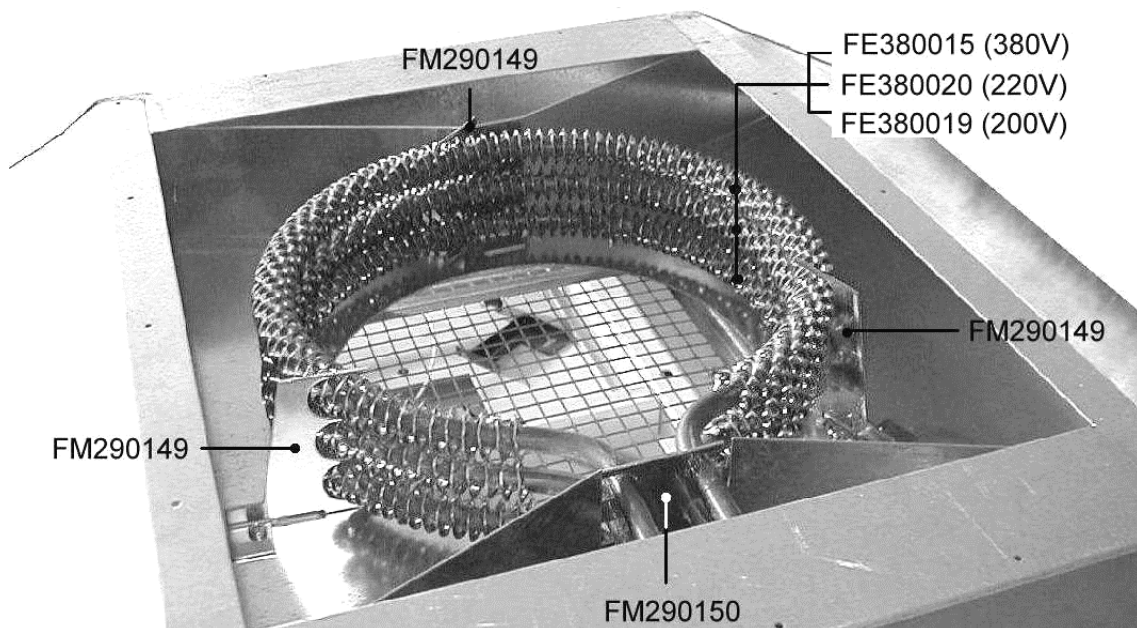

## WIRING GROUP (control panel)

## SCHEME 11

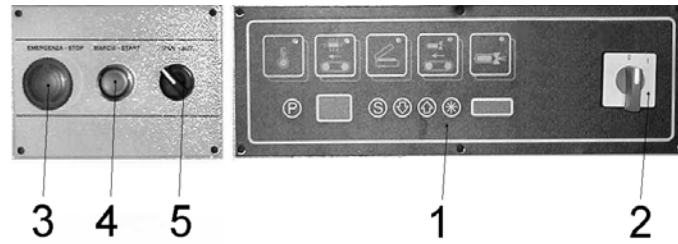

POS.	ITEMS CODE	ITEMS DESCRIPTION	Q.ty
1	S0190056	Panel + electronic board	1
1.1	FE120363	Electronic board	1
2	FE080001	Switch	1
3	FE340005	Emergency pushbutton	1
4	FE340001	Start button	1
5	FE085004	Manual selector	1

## WIRING GROUP (box)

## SCHEME 11.1

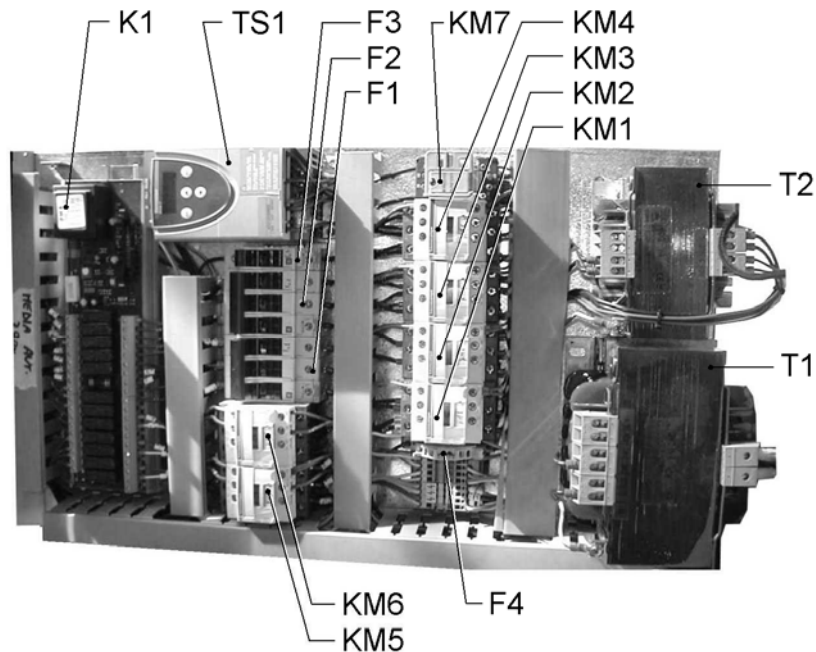

POS.	ITEMS CODE	ITEMS DESCRIPTION	Q.ty
F1	FE290405 FE290407 FE290408	Fuse 10.3X38 AM 10A (380/415V) Fuse 10.3X38 AM 16A (230V) Fuse 10.3X38 AM 20A (200/208V)	3
F2	FE290401	Fuse 10.3X38 AM 2A	3
F3	FE290401	Fuse 10.3X38 AM 2A	1
F4	FE290121	Fuse 5X20 T 2A	1
KM1	FE110615	Contactore LC1-D18B7	1
KM2	FE110602 FE110615	Contactore LC1-D09B7 (380/415V) Contactore LC1-D18B7 (200/208/230V)	1
KM3	FE110602	Contactore LC1-D09B7	1
KM4	FE110602	Contactore LC1-D09B7	1
KM5	FE110602	Contactore LC1-D09B7	1
KM6	FE110602	Contactore LC1-D09B7	1
KM7	FE370006	Relay 24VAC	1
K1	FE120353	Electronic control board	1
TS1	KR170001	Inverter	1
T1	FE440613 FE440612	Transformer 2400VA (380/415V) Transformer 2400VA (200/208/230V)	1
T2	FE440026 FE440025	Transformer 400VA (380/415V) Transformer 400VA (200/208/230V)	1

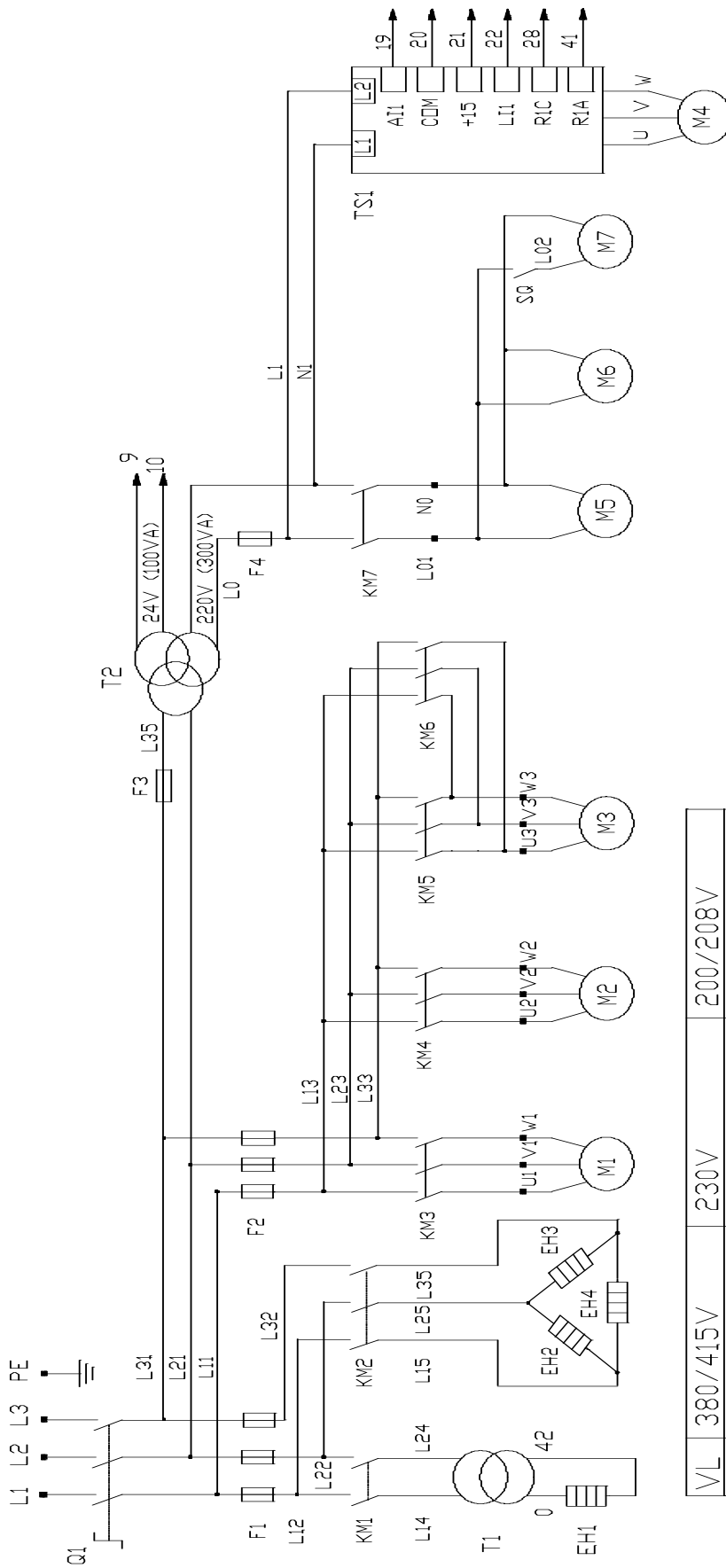

VL	380/415V	230V	200/208V
F1	AM 10A 450V	AM 16A 450V	AM 20A 450V
F2	AM 2A 450V	AM 2A 450V	AM 2A 450V
F3	AM 2A 450V	AM 2A 450V	AM 2A 450V
F4	T 2A 250V	T 2A 250V	T 2A 250V
FU	T 2A 250V	T 2A 250V	T 2A 250V



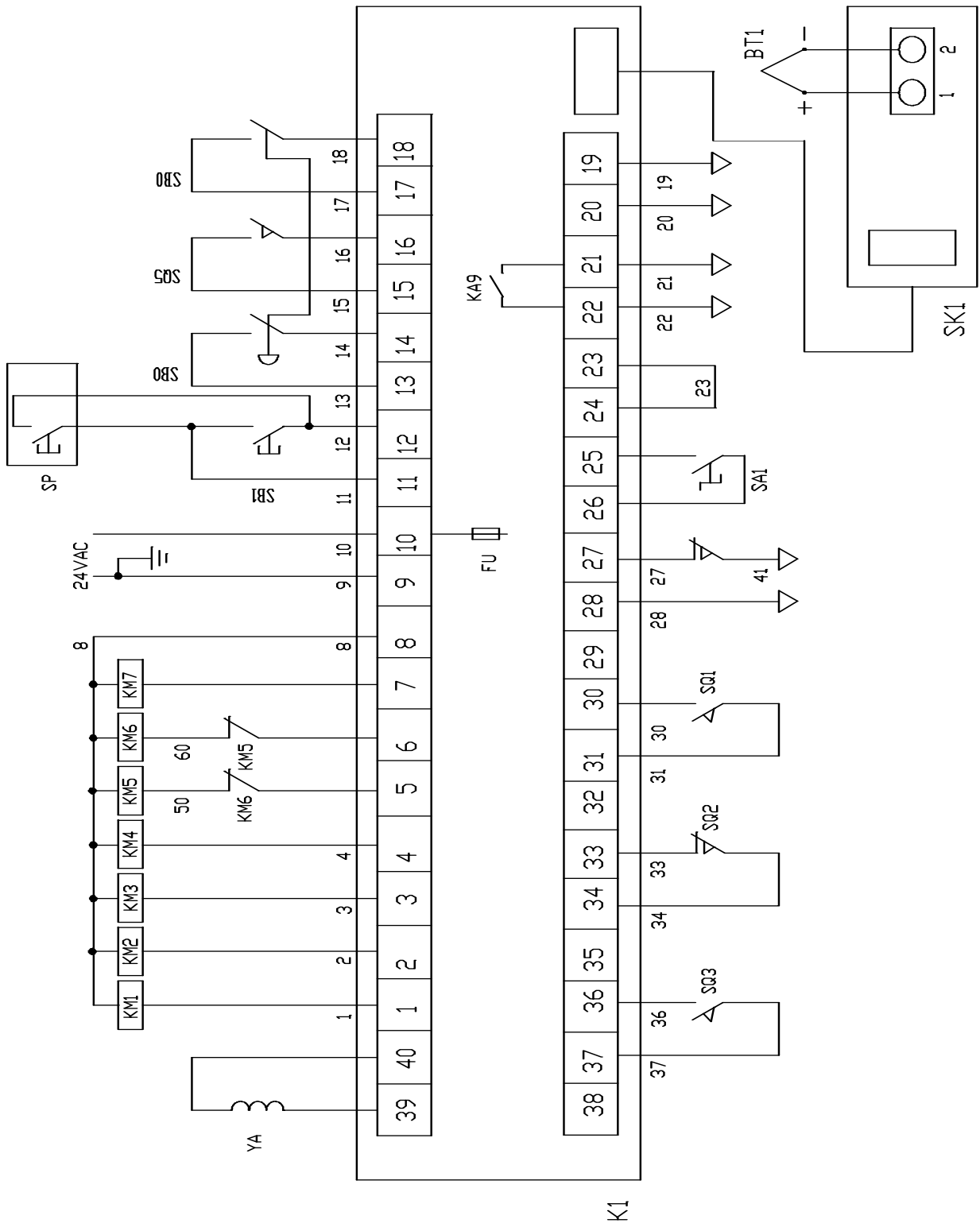

	Q1	Main switch
	F1	Sealing blade / heaters fuse 10.3X38
	F2	Fan / belt / frame motor fuse 10.3X38
	F3	Auxiliary transformer fuse 10.3X38
	F4	Ventilator / pump motor fuse 5X20
	FU	Board fuse 5X20
	EH1	Cutting resistance
	EH2	Heater
	EH3	Heater
	EH4	Heater
	M1	Fan motor
	M2	Belt motor
	M3	Frame drive motor
	M4	Belt oven motor
	M5	Ventilator motor
	M6	Pump motor
	M7	Winder motor
	T1	Cut transformer
	T2	Auxiliary transformer
	SQ	Winder limit switch
	SQ1	Frame lowering limit switch
	SQ2	Frame lifting limit switch
	SQ3	Safety device cutting out limit switch
	SQ5	Safety limit switch
	KM1	Cutting contactor
	KM2	Heaters contactor
	KM3	Fan contactor
	KM4	Sealing belt contactor
	KM5	Frame descent contactor
	KM6	Frame rise contactor
	KM7	Accessories contactor
	SB0	Emergency pushbutton
	SB1	Start button
	SA1	Manual selector
	YA	Sealing magnet
	SP	Foot pedal
	BT1	Thermocouple
	K1	Electronic control board
	SK1	Control board
	TS1	Inverter



## ***Minipack-torre S.p.A.***

*Via Provinciale, 54 - 24044 DALMINE (BG) - ITALY*

*Tel. (035) 563525 – Fax (035) 564945*

*E-mail: [info@minipack-torre.it](mailto:info@minipack-torre.it)*

*<http://www.minipack-torre.it>*