



Minipack-torre S.p.A.
Via Provinciale, 54 - 24044 Dalmine (BG) - Italy
Tel. (035) 563525
E-mail: info@minipack.it
<http://www.minipack.it>



Tunnel 50 Digit

Spare parts catalogue

(Valid from serial number 4807 dated 11.2010)

REV.02: modified colour from grey RAL7032 to grey RAL7035.



CAREFULLY READ THIS CATALOGUE BEFORE ORDERING ANY SPARE PART



DOC. N. FM112079
REV. 02
ED. 01.2022

ITEMS DESCRIPTION	SCHEME 1
--------------------------	-----------------

Pos.	Code	Description
1.01	FM095611 FM095613 FM096396	Upper case colour RAL7035B. Stainless steel upper case Steel it upper case
1.02	FM095307 FM095431 FM096395	Rear case colour RAL7035B. Stainless steel rear case Steel it rear case
1.03	FM095308 FM095345 FM096383	Side case colour RAL7035B. Stainless steel side case Steel it side case
1.04	FM095456 FM095458 FM096397	Bedplate colour RAL7035B. Stainless steel bedplate Steel it bedplate
1.05	FM095486 FM095488 FM096394	Front body side fairing colour RAL7035B. Stainless steel front body side fairing Steel it front body side fairing
1.06	FM090394 FM090425 FM095883	Bedplate leg colour RAL7035B. Stainless steel bedplate leg Steel it bedplate leg
1.07	FM095471 FM095473 FM096382	Door colour RAL7035B. Stainless steel door Steel it door
1.08	FM510084	Hinge
1.09	FM510081	Closure
1.10	FM770511 FM770525	Wheel Ø100 Wheel Ø100 inox-steel it version
1.11	FM770512 FM770526	Wheel Ø100 with brake Wheel Ø100 with brake inox-steel it
1.12	KR090006	Protection kit (optional)
1.15	FM091114	Fairing
1.16	FE435004	Thermocouple
1.17	FM282005	Right air deflector
1.18	FM282006	Left air deflector
1.19	FM230012	Fan protection
1.20	FM290207	Curtain support
1.21	FM160072	Insulating spacer

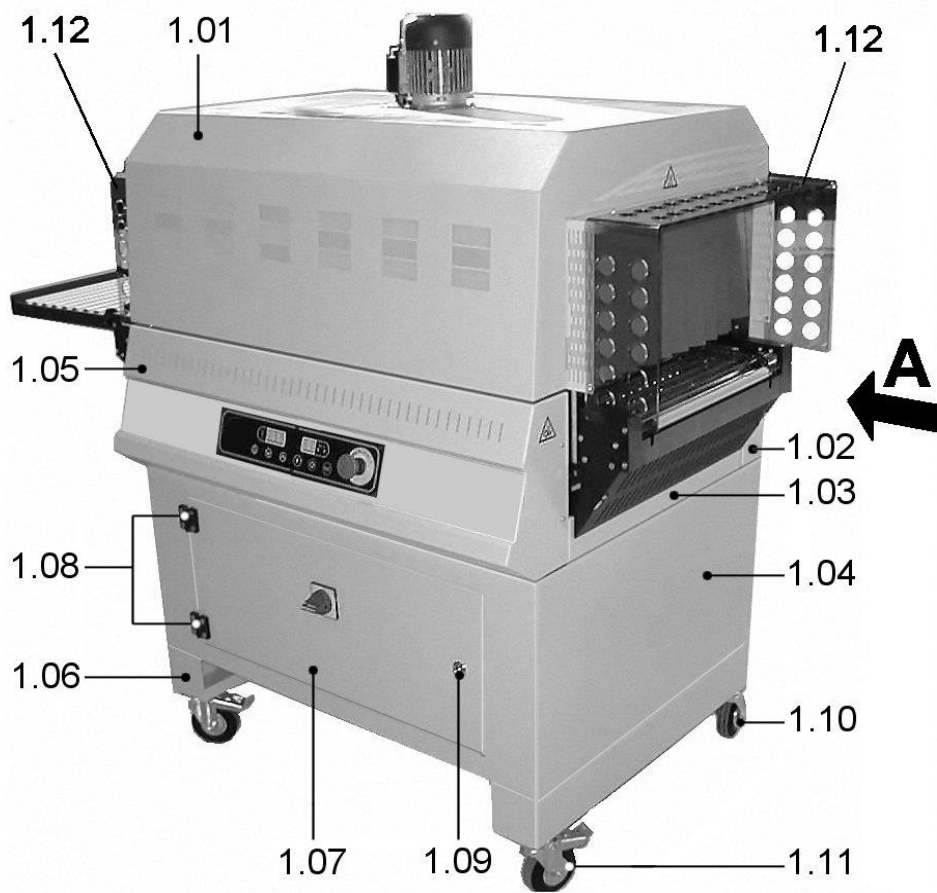

Vista da A

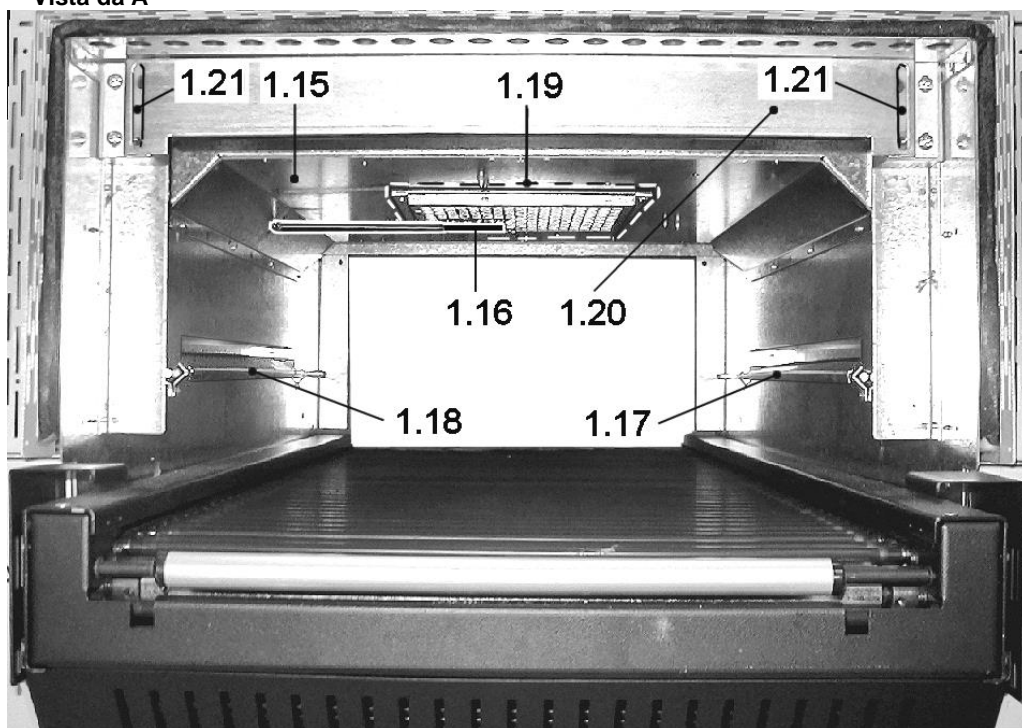

ITEMS DESCRIPTION	SCHEME 2
--------------------------	-----------------

Pos.	Code	Description
2.01	FM150105	Knob
2.02	P0K00500	Inlet curtain kit
2.03	FM095562 FM095563 FM096392	Left guard colour black Stainless steel left guard Steel it left guard
2.04	FM095532 FM095533 FM096391	Right guard colour black Stainless steel right guard Steel it right guard
2.05	FM095451 FM095452 FM096390	Inlet chain case colour black Stainless steel inlet chain case Steel it inlet chain case
2.06	KR090004	Belt height regulation kit
2.10	FM200090	Pin for idle roll
2.11	FM300159 FM300191 FM300391	Right belt crosspiece colour black Stainless steel right belt crosspiece Steel it right belt crosspiece
2.12	FM250014	Inlet idle roll
2.13	FM095208	Belt inlet protection case
2.15	KR090011	Idle pinion kit
2.16	FM010028	Belt countershaft
2.17	FM610710	Support
2.18	FM160214	Spacer
2.19	KR090023	Pinion kit

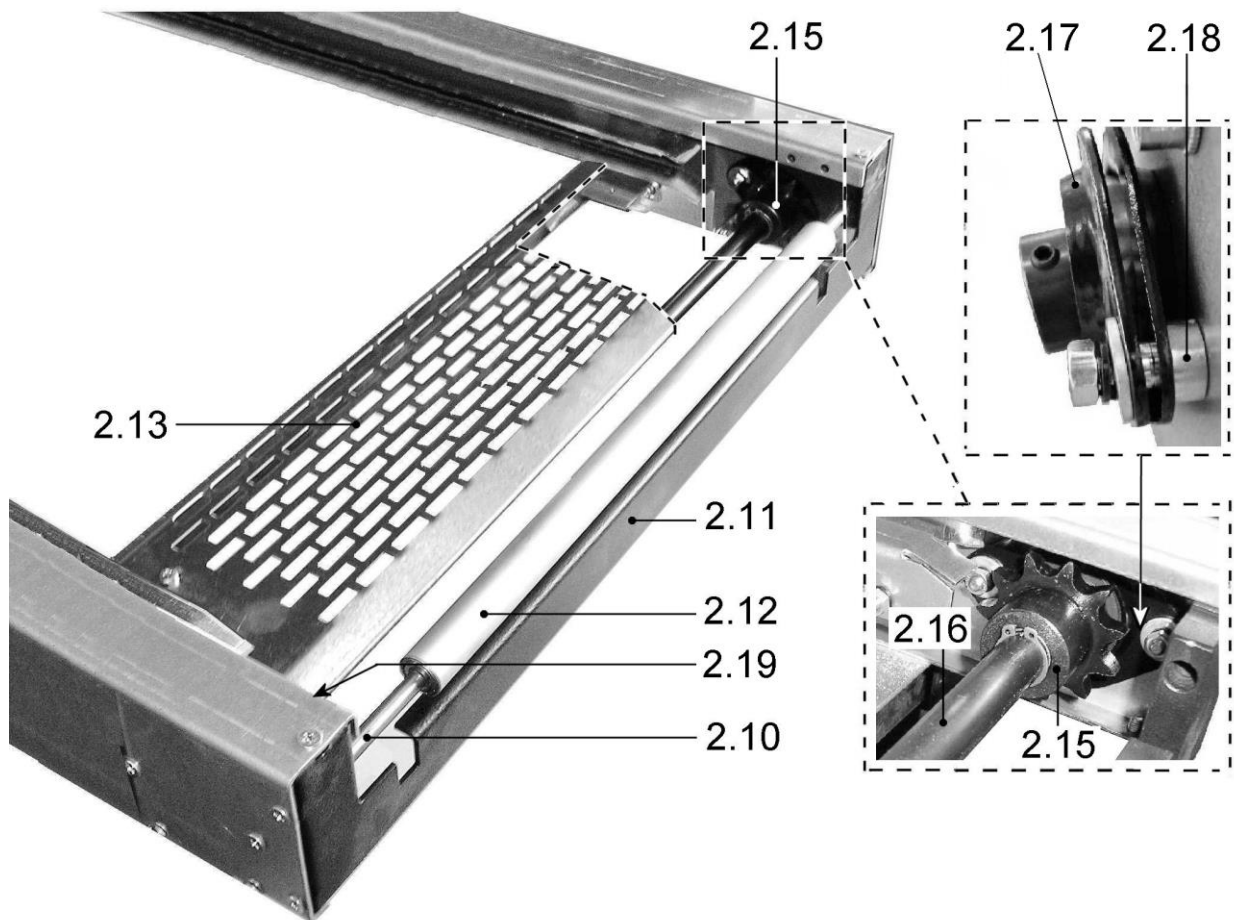
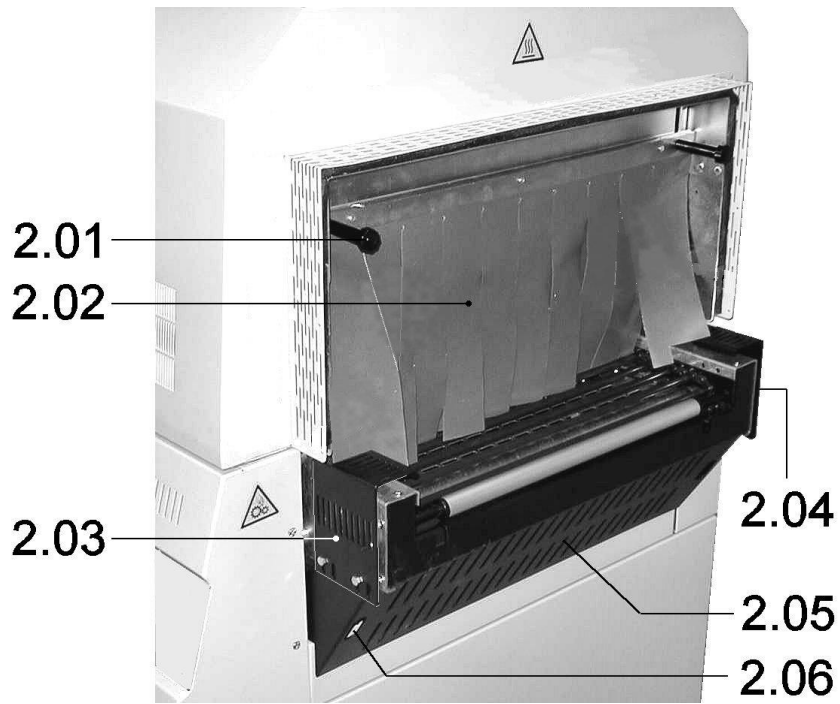

ITEMS DESCRIPTION	SCHEME 3
--------------------------	-----------------

Pos.	Code	Description
3.01	RU020000 RU020003 RU020005 RU020001	Roller table 40x50 colour black Stainless steel roller table 40x50 Steel it roller table 40x50 Roller table 40x100 colour black (optional)
3.02	FM710305	Idle roll
3.03	AS250026	Outfeed rool
3.04	FM510037	Fixed lever
3.05	POK00501	Outlet curtain kit
3.06	FM150105	Knob
3.07	FM095475 FM095079 FM096393	Outlet chain case colour black Stainless steel outlet chain case Steel it outlet chain case
3.08	FM095536 FM095537 FM096387	Left guard colour black Stainless steel left guard Steel it left guard
3.09	FM095534 FM095535 FM096386	Right guard colour black Stainless steel right guard Steel it right guard
3.10	FM270061 FM270072	Rear belt shoulder colour black Stainless steel rear belt shoulder
3.11	FM270062 FM270073	Front belt shoulder colour black Stainless steel front belt shoulder
3.12	FM760023	Reduction gear
3.13	FE240080	Motor H56 HP0,12 B14
3.14	FM300195 FM300196 FM300392	Left belt crosspiece colour black Stainless steel left belt crosspiece Steel it left belt crosspiece
3.15	FM095209	Belt outlet protection case
3.16	FM140057	Left chain fastening guide
3.17	FM140040	Right chain fastening guide
3.18	FM140058	Chain / Roll guide
3.19	FM200068	Conveyor belt pin
3.20	FM150102	Regulation handwheel
3.21	FM280033	Roll guide fastening square
3.22	KR090023	Pinion kit
3.23	FM010029	Conveyor belt motor shaft
3.24	FM250027	Belt motor roll
3.25	KR090025	Roll with gaskets kit

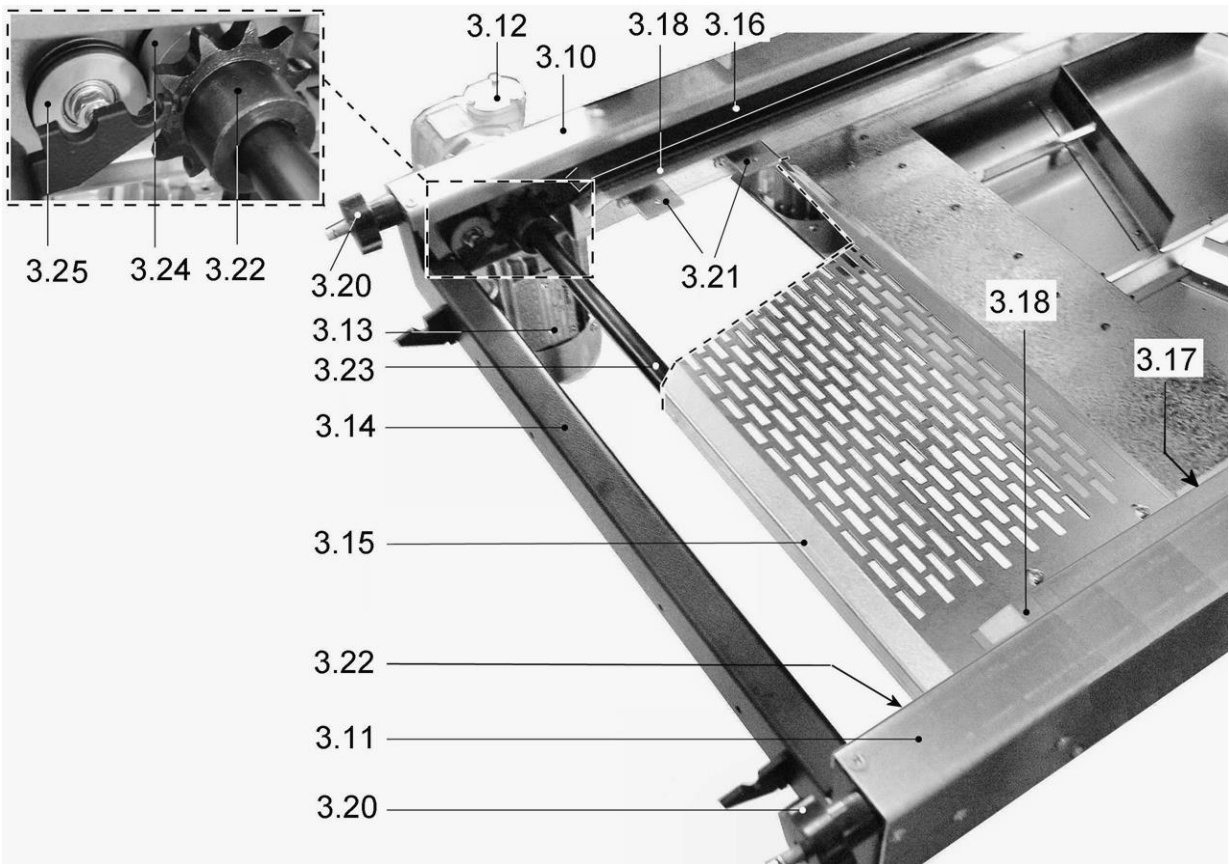
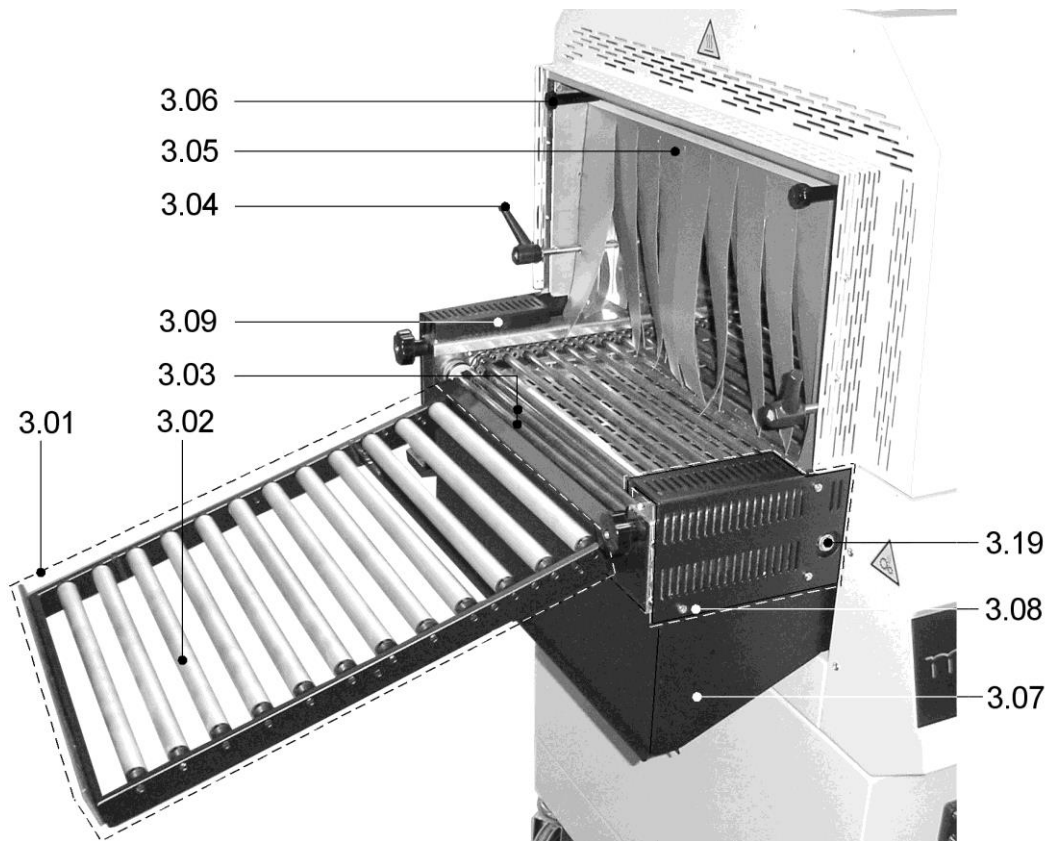

ITEMS DESCRIPTION	SCHEME 4
--------------------------	-----------------

Pos.	Code	Description
4.01	CT090002	Standard complete conveyor belt
4.02	AS250052	Chain fastening roll
4.03	AS250047	Roll for chain
4.04	FM100015	Chain with holed pins
4.05	KR090026	Rollers kit
4.11	NT090001	Complete stainless steel conveyor belt (optional)
4.21	FM710010	Teflon conveyor belt (optional)

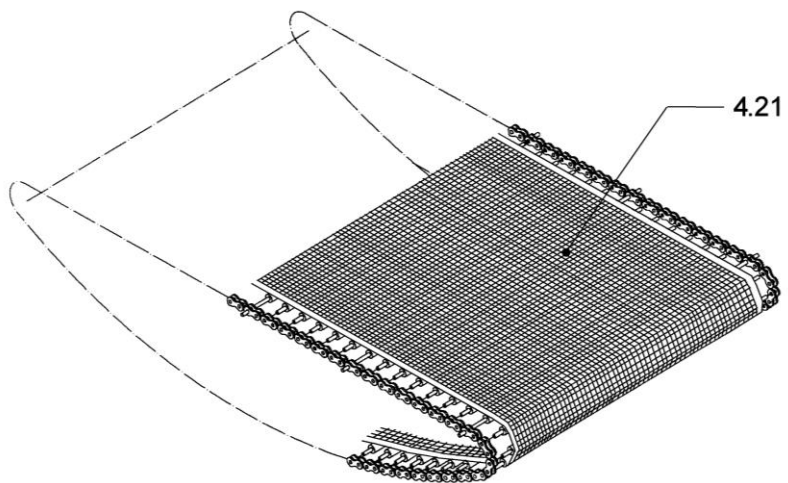
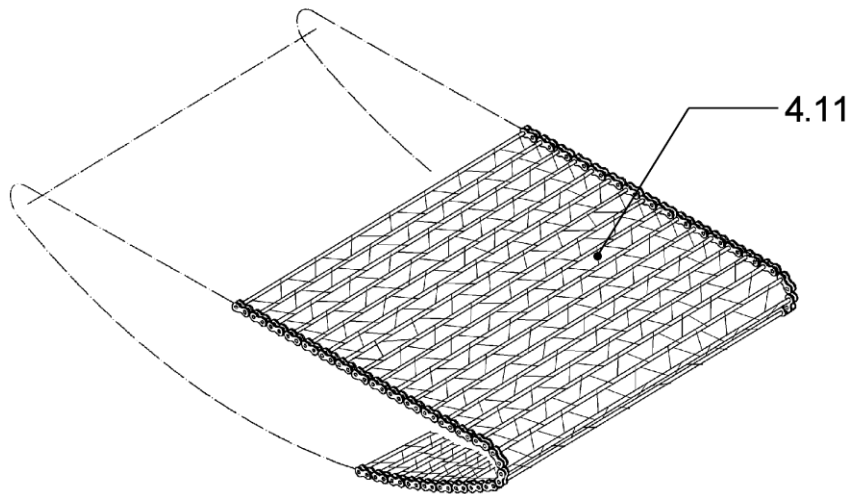
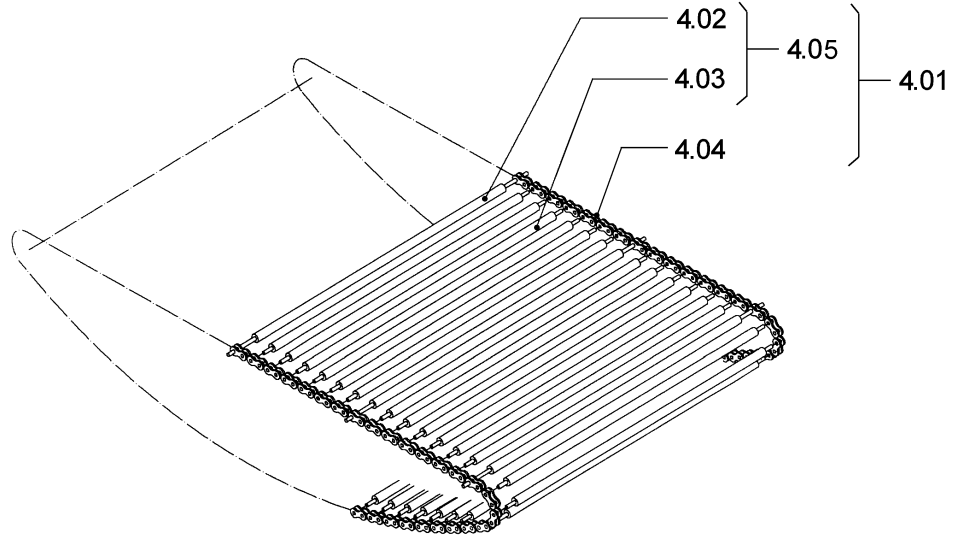

ITEMS DESCRIPTION	SCHEME 5
--------------------------	-----------------

Pos.	Code	Description
5.01	FM290194	Motor support plate
5.02	FE240070 FE240071	Three-phase motor 230-380-415-440V Three-phase motor 200-208V
5.03	FM830052	Fan
5.04	FM290255	Single resistor support
5.05	FM290249	Double resistor support
5.06	FE380010 FE380021	2300W 230-380-415-440V resistor 2300W 200-208V resistor

ITEMS DESCRIPTION	SCHEME 6
--------------------------	-----------------

Pos.	Code	Description
6.01	S0190091	Panel + electronic board
6.02	FE340005	Emergency pushbutton

MACHINE DETAIL DRAWING

SCHEME 5

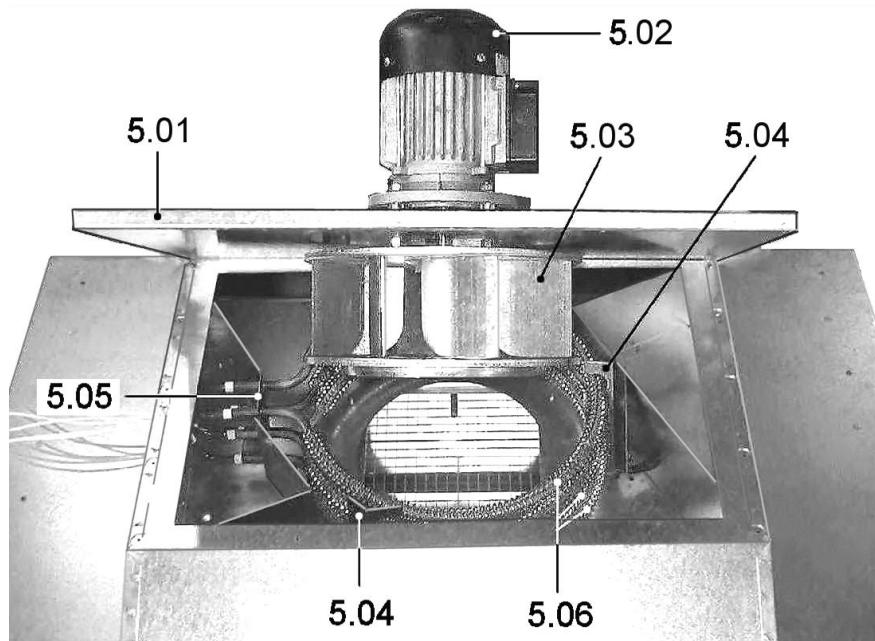

MACHINE DETAIL DRAWING

SCHEME 6



ITEMS DESCRIPTION	SCHEME 7.0
--------------------------	-------------------

Electrical system with "Schneider" inverter

Pos.	Code	Description
T1	FE440026 FE440025 FE440027	Transformer 400VA (400-415V) Transformer 400VA (200-208-230V) Transformer 400VA (440V)
TS1	KR090005	Inverter (Schneider)
F0	FE290401	Fuse 10.3X38 AM 2A
F1	FE290401 FE290402	Fuse 10.3X38 AM 2A (400-415-440V) Fuse 10.3X38 AM 4A (200-208-230V)
F2	FE290400	Fuse 10.3X38 AM 1A
F3	FE290400 FE290401	Fuse 10.3X38 AM 1A (400-415-440V) Fuse 10.3X38 AM 2A (200-208-230V)
F4	FE290405 FE290408	Fuse 10.3X38 AM 10A (400-415-440V) Fuse 10.3X38 AM 20A (200-208-230V)
QM0	FE110602	Contacteur LC1-D09B7
QM1	FE110602	Contacteur LC1-D09B7
QM2	FE110615 FE110608	Contacteur LC1-D18B7 (400-415-440V) Contacteur LC1-D25B7 (200-208-230V)
Q1	KR210092 KR210096	Three-pole switch kit 20A (400-415-440V) Three-pole switch kit 32A (200-208-230V)

ITEMS DESCRIPTION	SCHEME 7.1
--------------------------	-------------------

Electrical system with "Control Techniques" inverter

Pos.	Code	Description
T1	FE440026 FE440025 FE440027	Transformer 400VA (400V) Transformer 400VA (200-208-230V) Transformer 400VA (440V)
TS1	KR090031	Inverter (Control Techniques)
F0	FE290401	Fuse 10.3X38 AM 2A
F1	FE290401 FE290402	Fuse 10.3X38 AM 2A (400-440V) Fuse 10.3X38 AM 4A (200-208-230V)
F2	FE290401	Fuse 10.3X38 AM
F3	FE290400 FE290401	Fuse 10.3X38 AM 1A (400-440V) Fuse 10.3X38 AM 2A (200-208-230V)
F4	FE290405 FE290408	Fuse 10.3X38 AM 10A (400-440V) Fuse 10.3X38 AM 20A (200-208-230V)
QM0	FE110602	Contacteur LC1-D09B7
QM1	FE110602	Contacteur LC1-D09B7
QM2	FE110615 FE110608	Contacteur LC1-D18B7 (400-440V) Contacteur LC1-D25B7 (200-208-230V)
Q1	KR210092 KR210096	Three-pole switch kit 20A (400-440V) Three-pole switch kit 32A (200-208-230V)

MACHINE DETAIL DRAWING

SCHEME 7.0

Electrical system with "Schneider" inverter

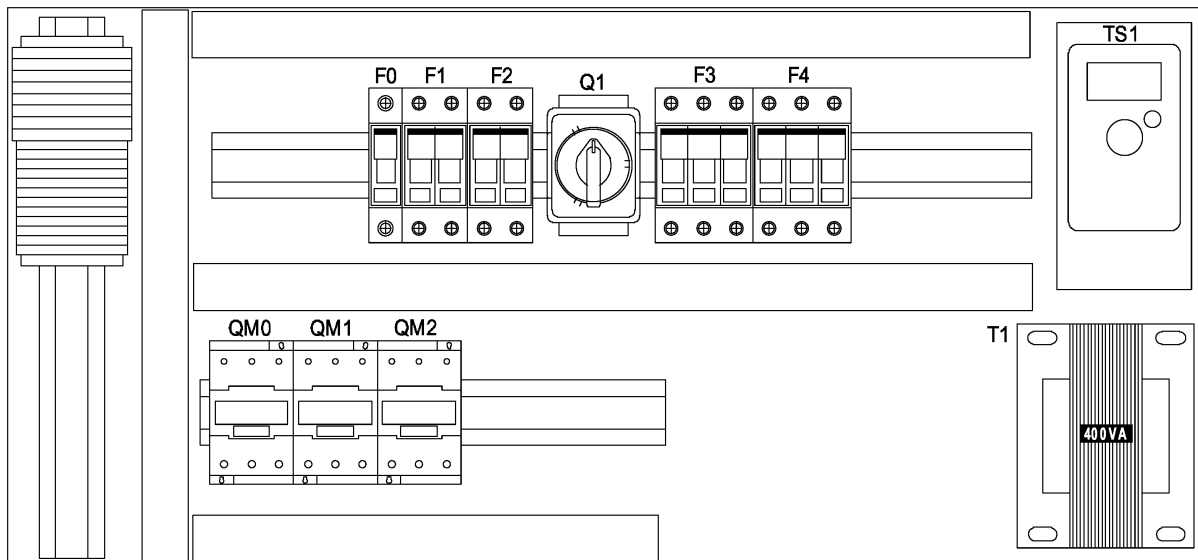

MACHINE DETAIL DRAWING

SCHEME 7.1

Electrical system with "Control Techniques" inverter

