



Minipack-torre S.p.A.
Via Provinciale, 54 - 24044 Dalmine (BG) - Italy
Tel. (035) 563525 – Fax (035) 564945
E-mail: info@minipack-torre.it
<http://www.minipack-torre.it>



Tunnel 50 Twin

Spare parts catalogue

(Valid from serial number 2702 dated 10.2004 up to 4850 dated 12.2010)



CAREFULLY READ THIS CATALOGUE BEFORE ORDERING ANY SPARE PART



DOC. N. FM112086
REV. 0
ED. 01.2011

ITEMS DESCRIPTION	SCHEME 1
--------------------------	-----------------

Pos.	Code	Description
1.01	FM095655	Upper case colour RAL7032B.
1.02	FM095654	Rear case colour RAL7032B.
1.03	FM095168	Side case colour RAL7032B.
1.04	FM095650	Bedplate colour RAL7032B.
1.05	FM095651	Front body side panel colour RAL7032B.
1.06	FM095657	Bedplate leg colour RAL7032B. (Tunnel x Continua).
	FM090369	Bedplate leg colour RAL7032B. (Tunnel x Sealmatic).
1.07	FM095470	Door colour RAL7032B.
1.08	FM510084	Hinge.
1.09	FM510081	Closure.
1.10	FM770509	Wheel D.100.
1.11	FM770510	Wheel D.100 with brake.
1.13	FM095660	Panneling bedplate leg colour RAL7032B. (only Tunnel x Continua).
1.15	FM095656	Fairing.
1.16	FE435004	Thermocouple.
1.17	FM280288	Right baffle.
1.18	FM280289	Left baffle.
1.19	FM230012	Fan protection.
1.20	FM290207	Supporto tendina.
1.21	FM095659	Panel for air flow limitation.
1.22	FM160072	Insulating spacer.

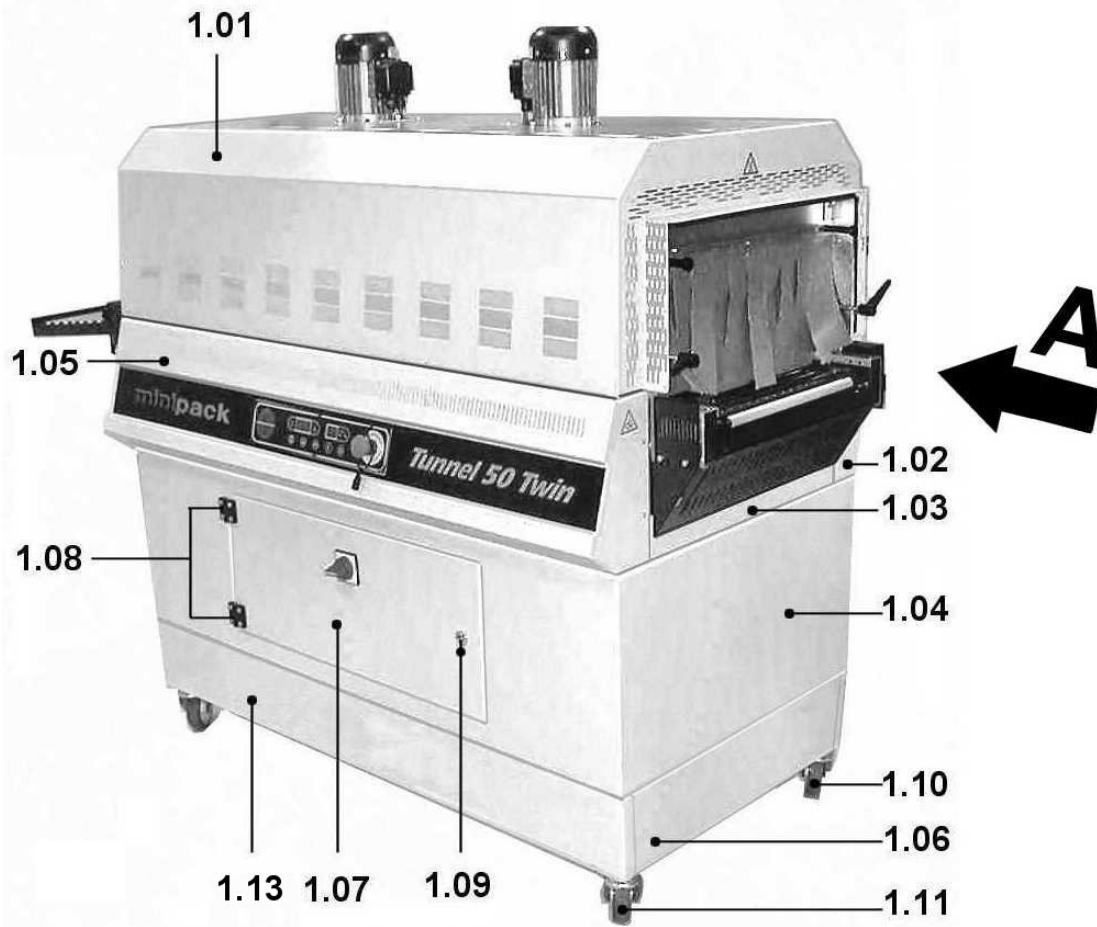

Vista da A

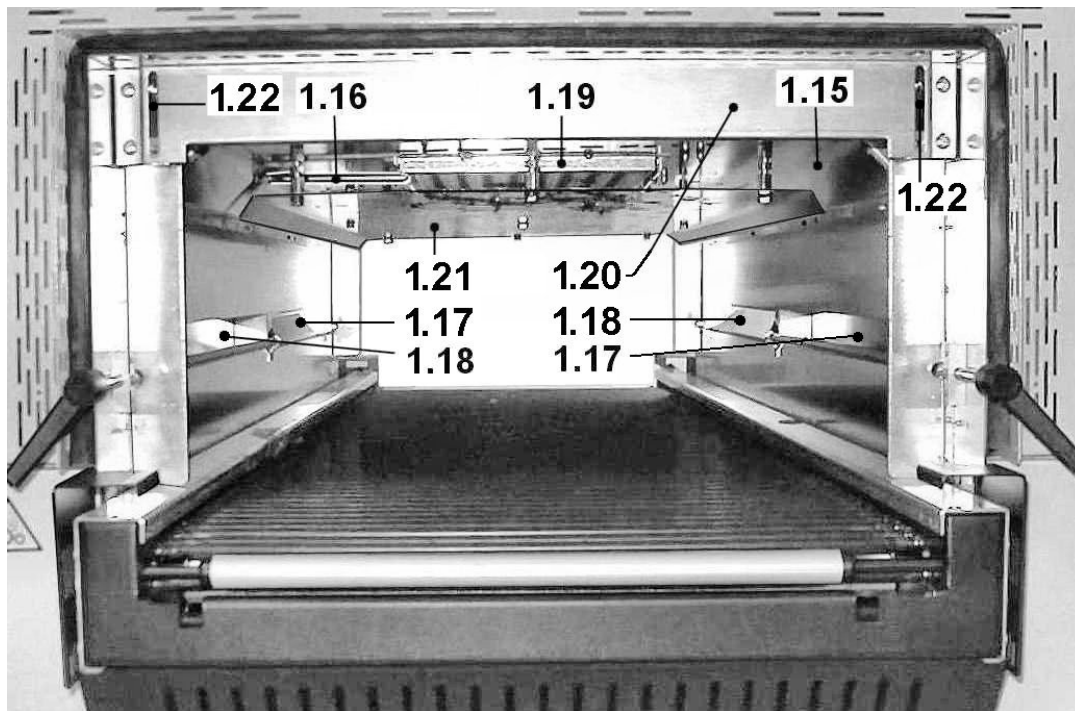

ITEMS DESCRIPTION	SCHEME 2
--------------------------	-----------------

Pos.	Code	Description
2.01	FM150105	Knob.
2.02	POK00500	Inlet curtain kit.
2.03	FM095562	Left guard colour black.
2.04	FM095532	Right guard colour black.
2.05	FM095451	Inlet chain case colour black.
2.06	KR090004	Belt height regulation kit.
2.07	FM510037	Fixed lever.
2.10	FM200072	Pin for idle roll (Valid up to serial number 3128 dated 01.2006)
	FM200090	Pin for idle roll (Valid from serial number 3129 dated 01.2006)
2.11	FM300159	Right belt crosspiece colour Black.
2.12	FM250009	Inlet idle roll (Valid up to serial number 3128 dated 01.2006)
	FM250014	Inlet idle roll (Valid from serial number 3129 dated 01.2006)
2.13	FM095208	Belt inlet protection case.
2.15	KR090011	Idle pinion kit.
2.16	FM010028	Belt countershaft.
2.17	FM610710	Support.
2.18	FM160214	Spacer.
2.19	FM260041	Conveyor belt pinion.

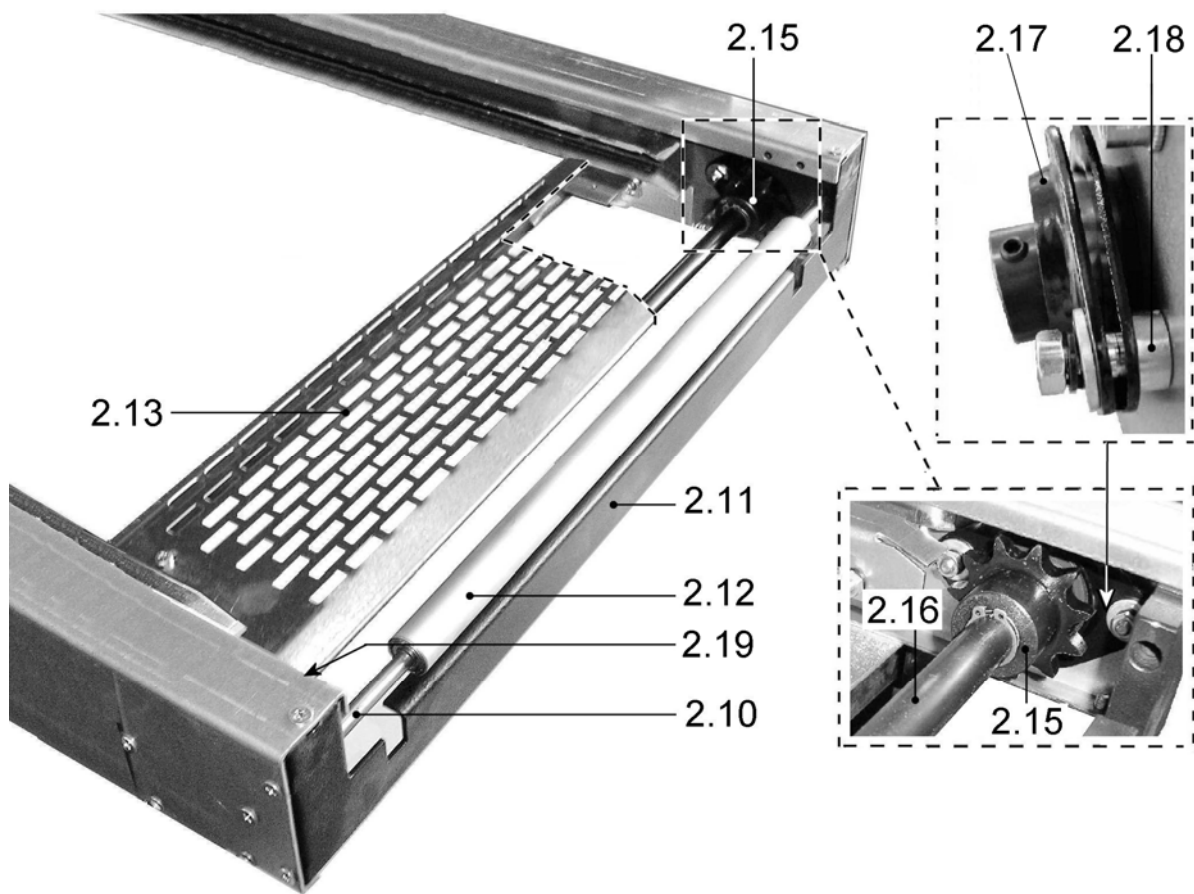
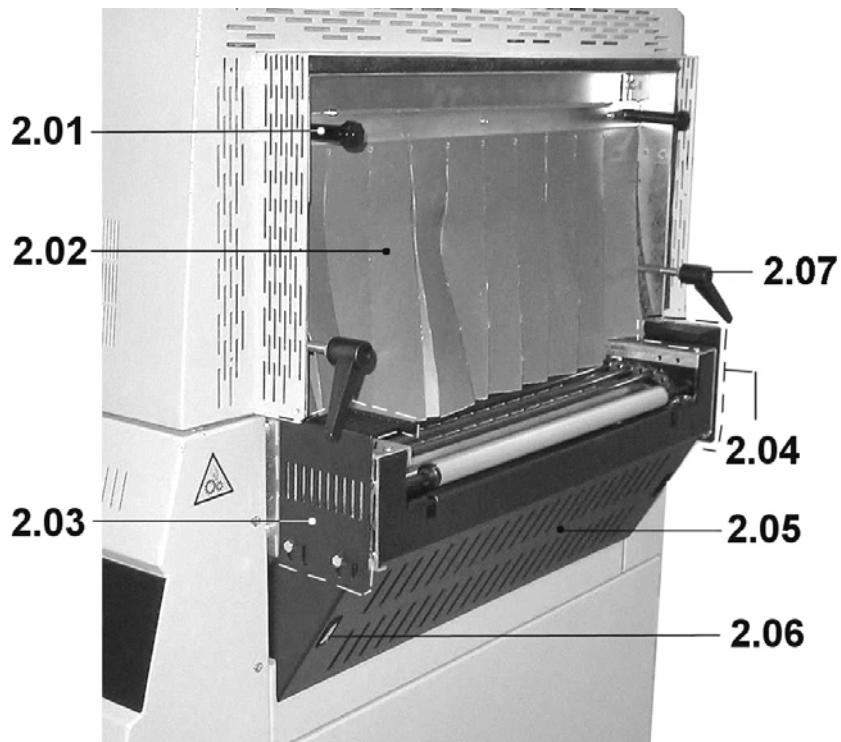

ITEMS DESCRIPTION	SCHEME 3
--------------------------	-----------------

Pos.	Code	Description
3.01	<i>RU020000</i>	<i>Roller table 40x50 (standard).</i>
	<i>RU020003</i>	<i>Stainless steel roller table 40x50 (optional).</i>
	<i>RU020001</i>	<i>Roller table 40x100 (optional).</i>
3.02	<i>FM710305</i>	<i>Idle roll.</i>
3.03	<i>FM710328</i>	<i>Outlet idle roll (Valid up to serial number 3065 dated 11.2005).</i>
	<i>AS250026</i>	<i>Outfeed rool (Valid from serial number 3066 dated 11.2005).</i>
3.04	<i>FM510037</i>	<i>Fixed lever.</i>
3.05	<i>POK00501</i>	<i>Outlet curtain kit.</i>
3.06	<i>FM150105</i>	<i>Knob.</i>
3.07	<i>FM095475</i>	<i>Outlet chain case colour black.</i>
3.08	<i>FM095536</i>	<i>Left guard colour black.</i>
3.09	<i>FM095534</i>	<i>Right guard colour black.</i>
3.10	<i>FM270040</i>	<i>Rear belt shoulder colour black.</i>
3.11	<i>FM270039</i>	<i>Front belt shoulder colour black.</i>
3.12	<i>FM760022</i>	<i>Reduction gear RMI 28 F 1:20 56B14</i>
3.13	<i>FE240087</i>	<i>Motor H63 HP 0,25 B14.</i>
3.14	<i>FM300158</i>	<i>Left belt crosspiece colour black (Valid up to serial number 2836 dated 03.2005).</i>
	<i>FM300193</i>	<i>Left belt crosspiece colour black (Valid from serial number 2837 dated 03.2005 to serial number 3065 dated 11.2005).</i>
	<i>FM300195</i>	<i>Left belt crosspiece colour black (Valid from serial number 3066 dated 11.2005).</i>
3.15	<i>FM095209</i>	<i>Belt outlet protection case.</i>
3.16	<i>FM140090</i>	<i>Right chain fastening guide.</i>
3.17	<i>FM140091</i>	<i>Left chain fastening guide.</i>
3.18	<i>FM140092</i>	<i>Chain / Roll guide.</i>
3.19	<i>FM200068</i>	<i>Conveyor belt pin.</i>
3.20	<i>FM150102</i>	<i>Regulation handwheel.</i>
3.21	<i>FM280033</i>	<i>Roll guide fastening square.</i>
3.22	<i>FM260041</i>	<i>Conveyor belt pinion.</i>
3.23	<i>FM010029</i>	<i>Conveyor belt motor shaft.</i>
3.24	<i>FM250027</i>	<i>Belt motor roll (Valid from serial number 3066 dated 11.2005).</i>
3.25	<i>FM250028</i>	<i>Transmission roll (Valid from serial number 3066 dated 11.2005).</i>

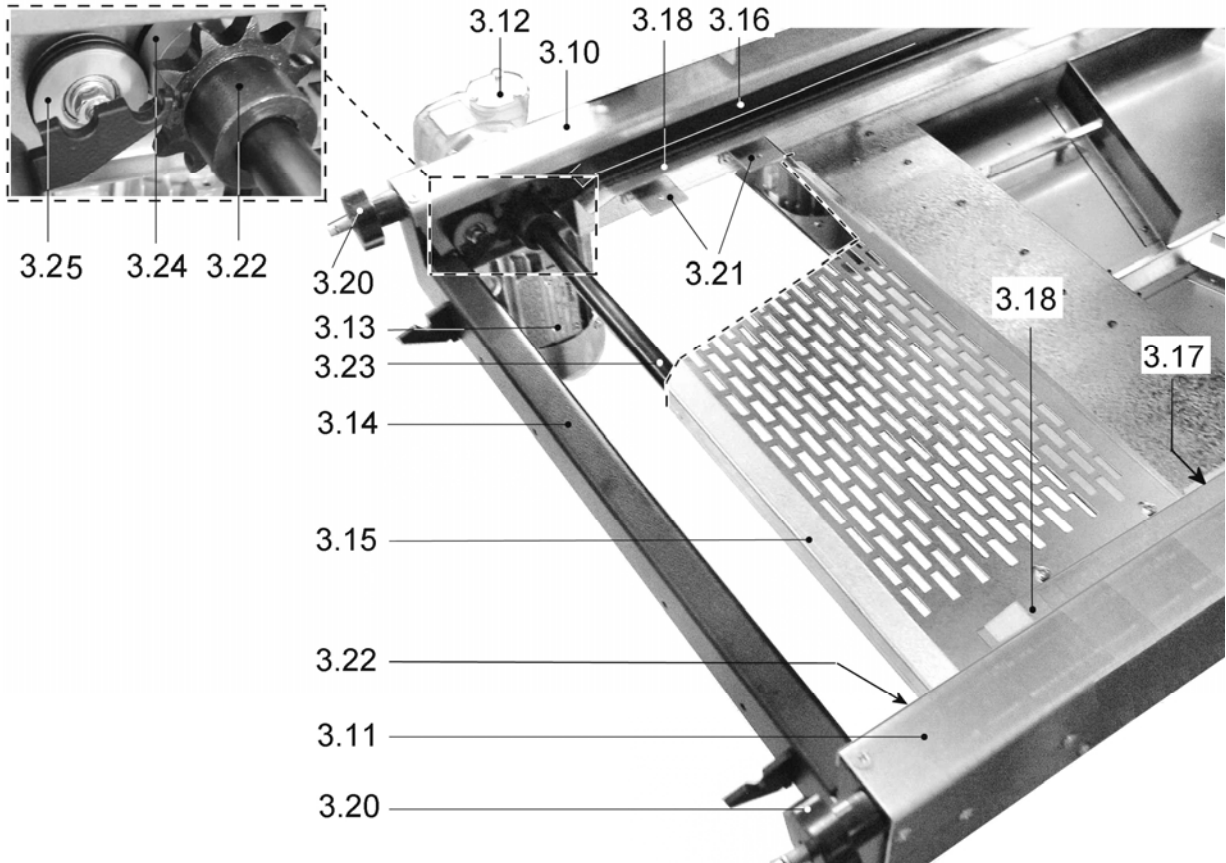
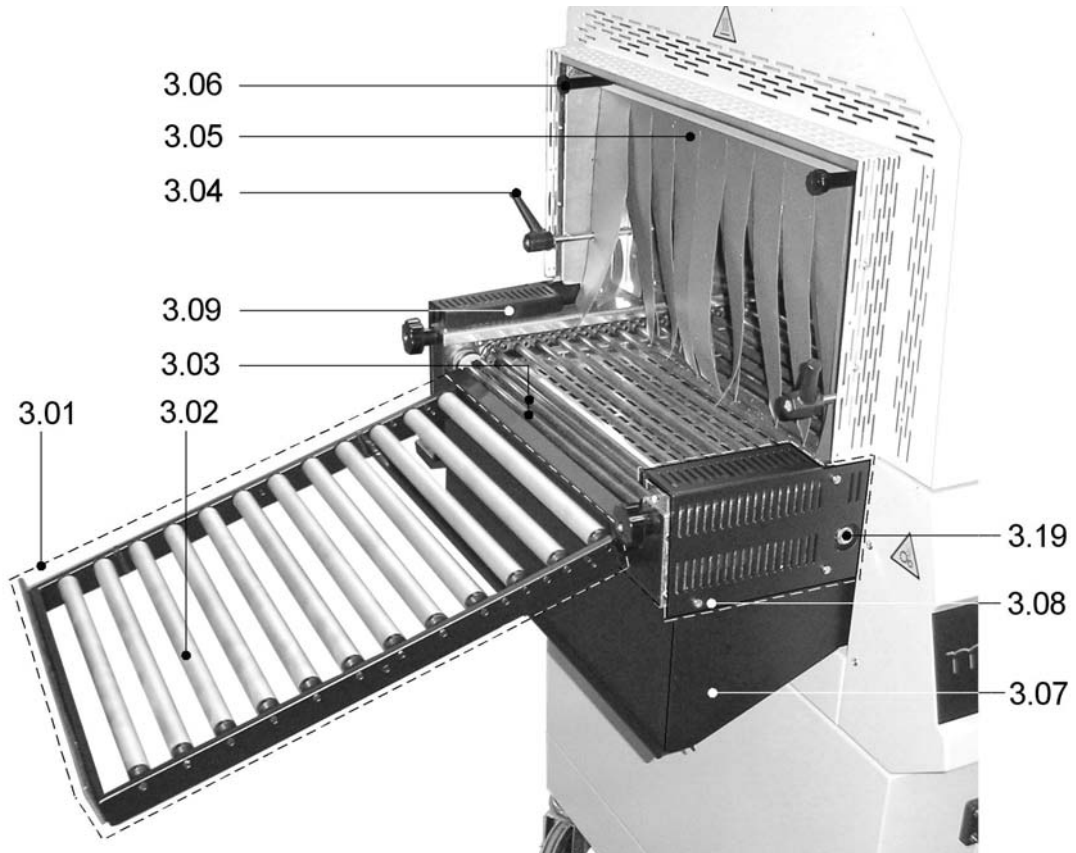

ITEMS DESCRIPTION	SCHEME 4
--------------------------	-----------------

Pos.	Code	Description
4.01	CT250001	Standard complete conveyor belt.
4.02	AS250048	Chain fastening roll.
4.03	AS250047	Roll for chain.
4.04	FM100019	Chain with holed pins.
4.11		Complete stainless steel conveyor belt (optional).
4.21	FM710015	Teflon conveyor belt (optional).

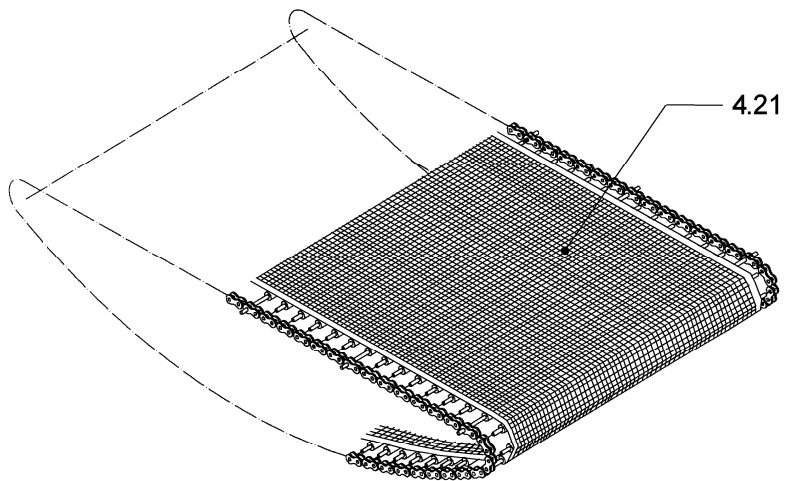
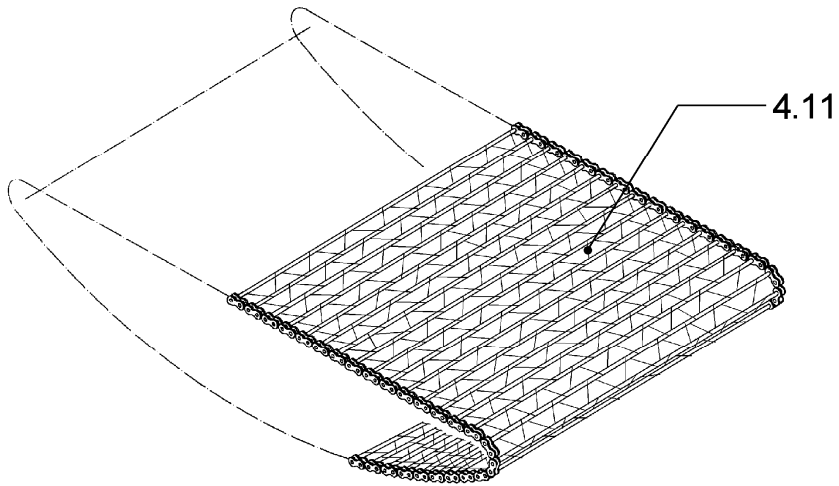
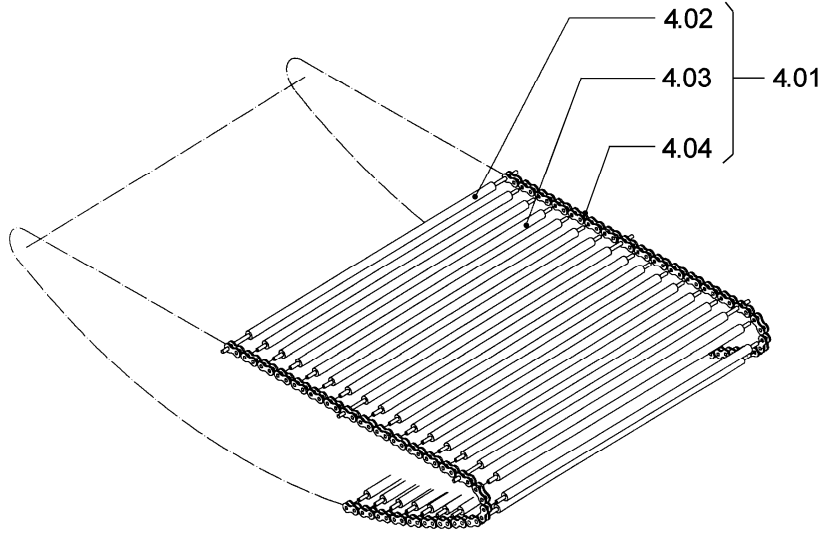

ITEMS DESCRIPTION	SCHEME 5
--------------------------	-----------------

Pos.	Code	Description
5.01	FM095658	Motor support plate.
5.02	FE240070 FE240071	Three-phase motor 230/380/415V. Three-phase motor 200/208V.
5.03	FM830052	Fan.
5.04	FM290255	Single heaters support.
5.05	FM290249	Double heaters support.
5.06	FE380010 FE380021	2300W 230/380/415V heater. 2300W 200/208V resistor.

ITEMS DESCRIPTION	SCHEME 6
--------------------------	-----------------

Pos.	Code	Description
6.01	FE440026 FE440025	Transformer 400VA (380/415V). Transformer 400VA (200/208/230V).
6.02	KR140005	Inverter.
6.03	FE290405 FE290408	Fuse 10.3X38 AM 10A (380/415V). Fuse 10.3X38 AM 20A (200/208/230V).
6.04	FE290401 FE290402	Fuse 10.3X38 AM 2A (380/415V). Fuse 10.3X38 AM 4A (200/208/230V).
6.05	FE290400	Fuse 10.3X38 AM 1A.
6.06	FE290401	Fuse 10.3X38 AM 2A.
6.07	FE290401 FE290402	Fuse 10.3X38 AM 2A (380/415V). Fuse 10.3X38 AM 4A (200/208/230V).
6.08	FE080031 FE080029	Three-pole switch 32A (380/415V). Three-pole switch 63A (200/208/230V).
6.09	FE110602	Contactator LC1-D09B7.
6.10	FE110615 FE110608	Contactator LC1-D18B7 (380/415V). Contactator LC1-D25B7 (200/208/230V).
6.11	FM090115	Electric installation plate.

ITEMS DESCRIPTION	SCHEME 7
--------------------------	-----------------

Pos.	Code	Description
7.01	S0190006	Panel + electronic board.
7.02	FE340005	Emergency pushbutton.
7.03	FE080035	Knob and plate for switch.

MACHINE DETAIL DRAWING

SCHEME 5

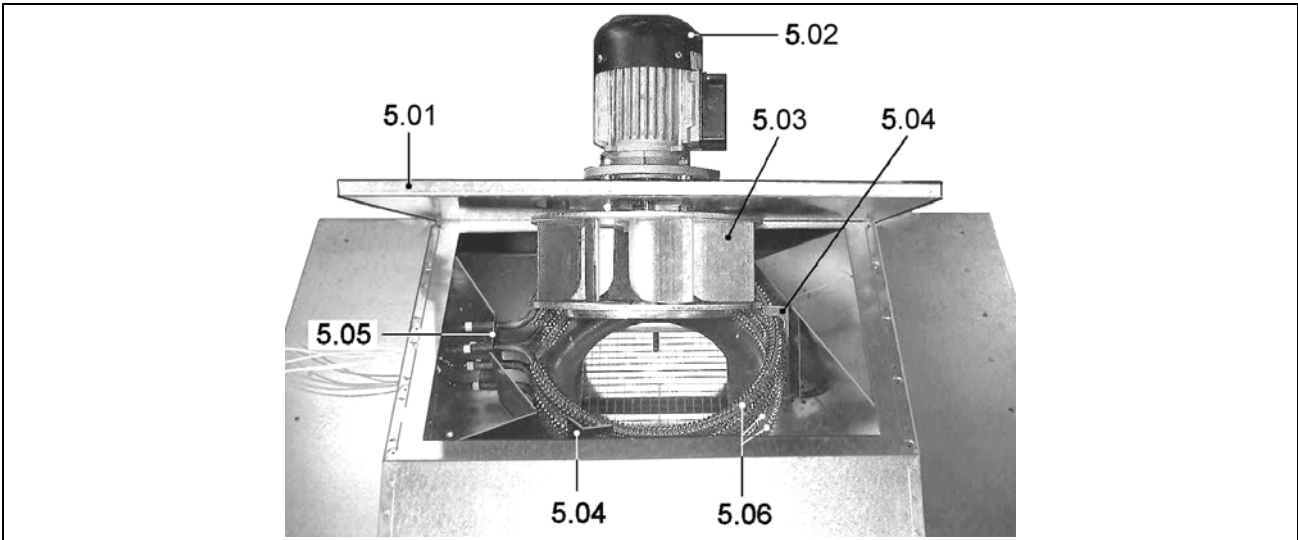

MACHINE DETAIL DRAWING

SCHEME 6

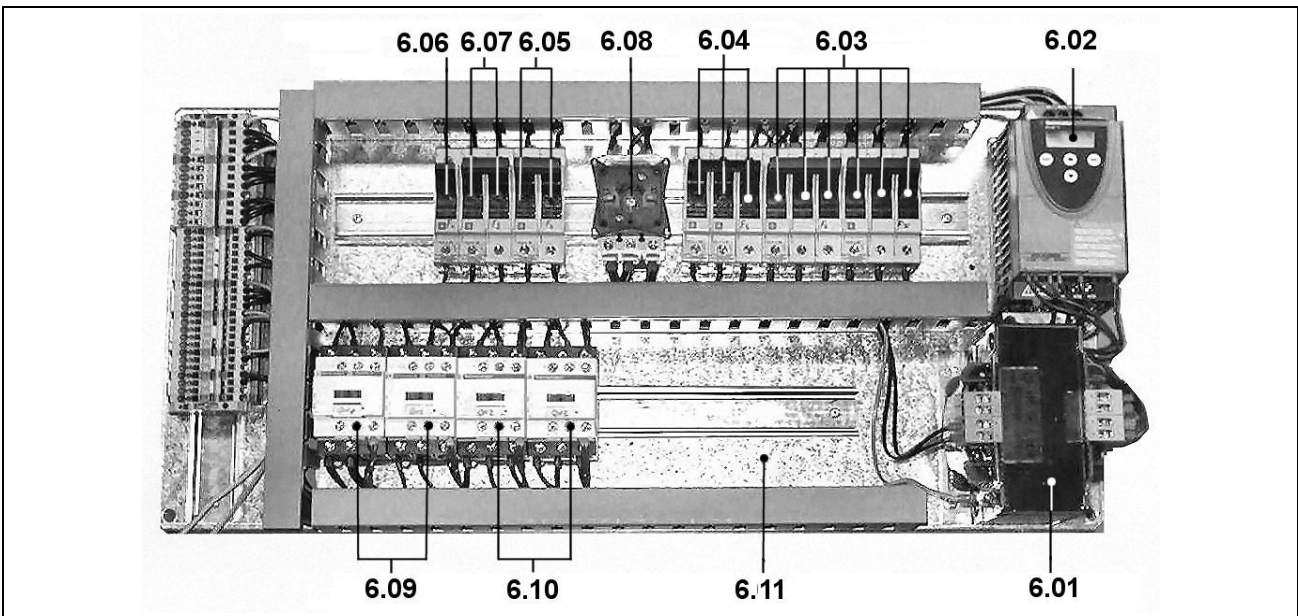

MACHINE DETAIL DRAWING

SCHEME 7



WIRING DIAGRAM DESCRIPTION

Pos.	Description
BT1	Thermocouple 1
BT2	Thermocouple 2
E1	Cooling fan 1
E2	Cooling fan 2
ER1	Heater 2
ER2	Heater 2
ER3	Heater 2
ER4	Heater 1
ER5	Heater 1
ER6	Heater 1
F0	Auxiliary fuse
F1	Transformer inlet fuses
F2	Inverter fuses
F3	Fan motor fuses
F4	Heaters fuses 2
F5	Heaters fuses 1
FM1	Fan motor guard 1
FM2	Fan motor guard 2
M1	Fan motor 1
M2	Fan motor 2
M3	Belt motor
Q1	Main switch
QM0	Inverter contactor
QM1	Fans motors contactor
QM2	Heaters contactor 2
QM3	Heaters contactor 1
S0	Emergency pushbutton
SK1	Control board
T1	Auxiliary transformer
TS1	Inverter

WIRING DIAGRAM

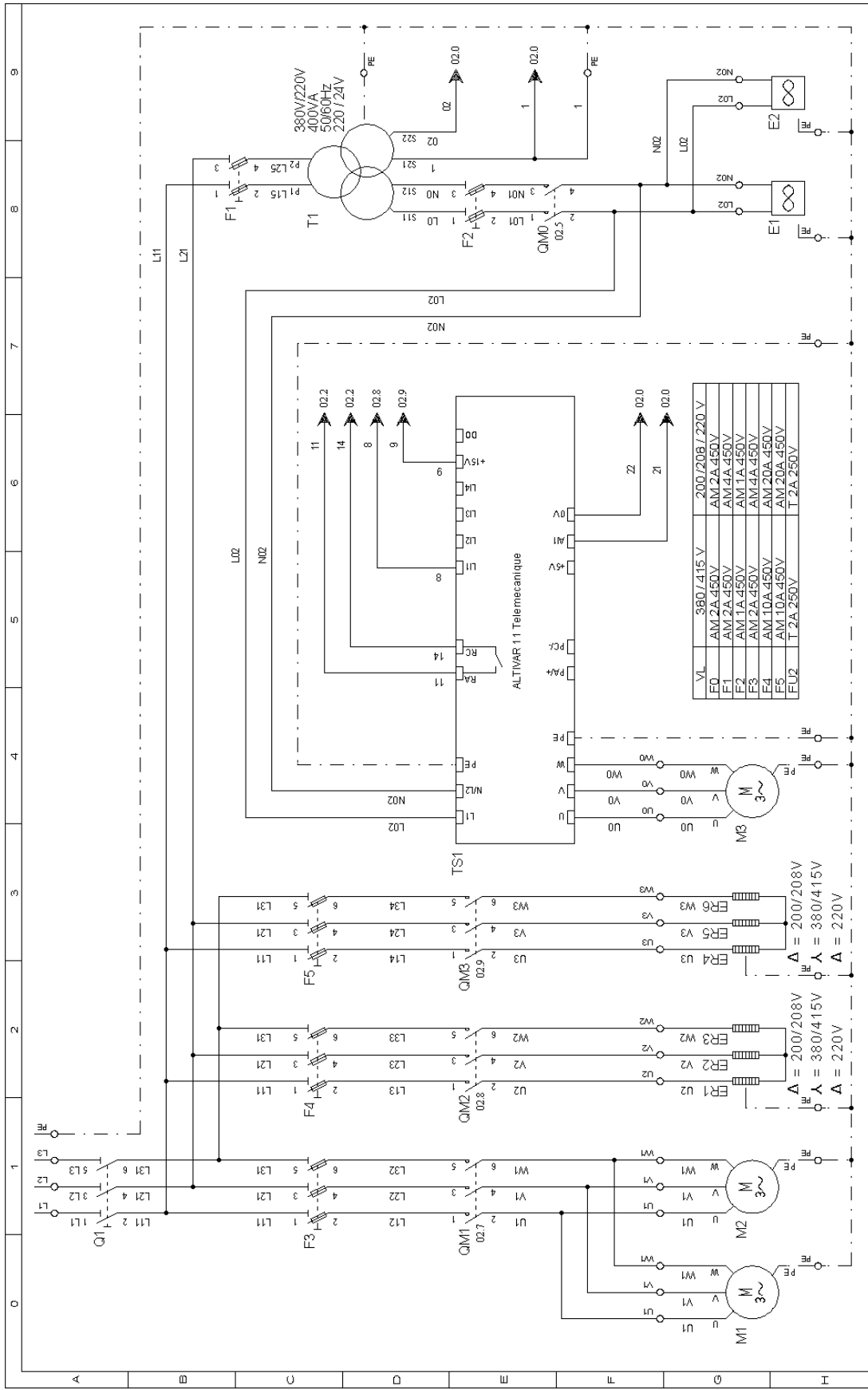

PROGETTO:	FOGLIO 01		
CODICE:	DI 02		
DESIGNOR:	WDMF2502		
TITOLO:	SCHEMA DI POTENZA		
DESIGNATORE:	Boldoni		
DATA:	20/04/2006		
REV	DATA	FIRMA	MODIFICA



Minipack-torre S.p.A.

Via Provinciale, 54 - 24044 DALMINE (BG) - ITALY

Tel. (035) 563525 – Fax (035) 564945

E-mail: info@minipack-torre.it

Internet: www.minipack-torre.it