

How to replace MVS 45 series lid shocks, gas springs, or lift cylinders.

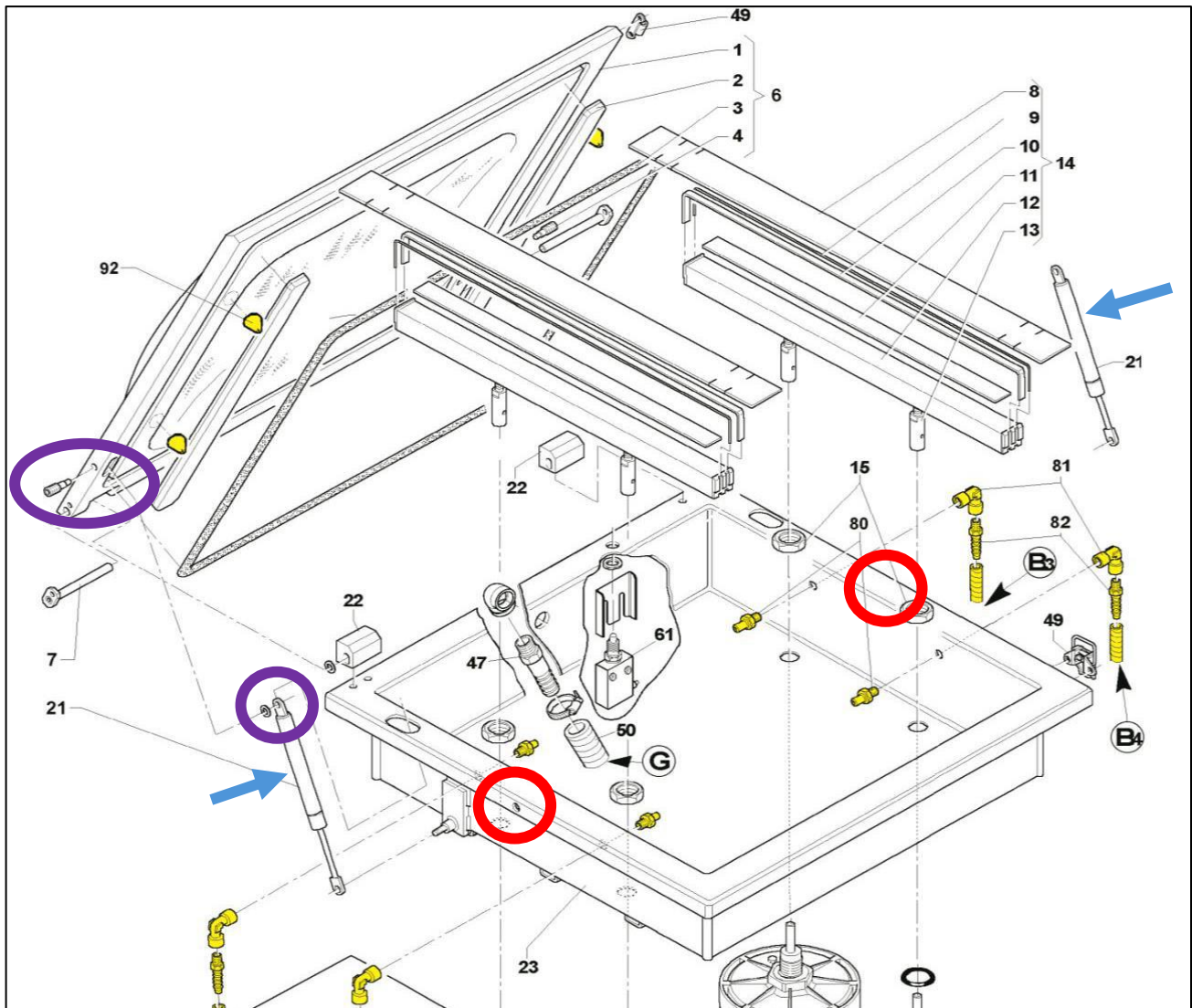

1. Remove the left and right out side lips chamber-to-body mounting screws using a 2.5 mm hex wrench. (Refer to red circles in the picture above.)
2. Carefully lift out/up the chamber about 8 inches, spin it 45 degree counter clockwise, and rest the chamber on the body top edges.
3. The 2 lid shocks are shown by the 2 blue arrows.
NOTE the orientation and mounting of the lid shocks between the lid and chamber.
Support the lid properly when removing the lid shocks.
4. When attaching the lid shock to the lid, make sure the screw is threaded properly through the lid, through the lid shock, and into the lid. (Refer to purple circles in the picture above.)
5. Once installed, both new lid shocks should have a little "play"/loose for smooth operation.

Minipack does not assume any responsibility or liability for the advice given and shall not be liable for any direct, indirect, special, incidental, or consequential damages in connection with the use of this information.